

Green dash line denotes extent of 1.8m high proposed sound barrier in Stage 1

Blue dash line denotes extent of 2.3m high proposed sound barrier in Stage 1

Red dash line denotes separation of Stage 1 & Stage 2

TA denotes a turnaround area for vehicles in Stage 01 and will be converted to park and Lot 83 in Stage 02

Park 01 will be 6640 m2 once Stage 02 is complete

Total Residential Area in Stage 1 43850m²

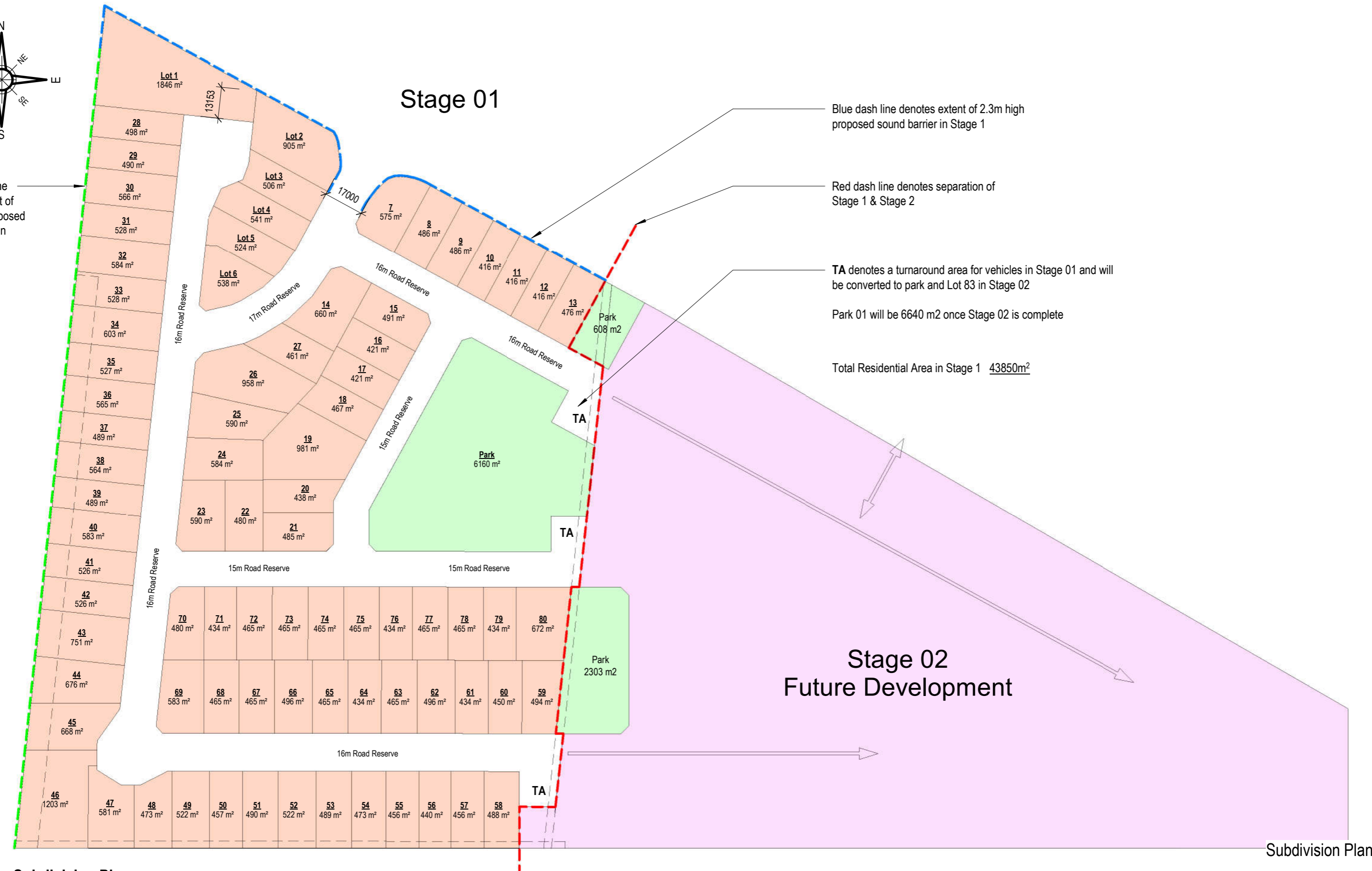

Subdivision Plan
1:1500 @ A3

Subdivision Plan

Proposed Subdivision

Mobile: 0427 796 140
Email: brad@crtpc.com.au
www.cunningtonrossetownplanning.com.au



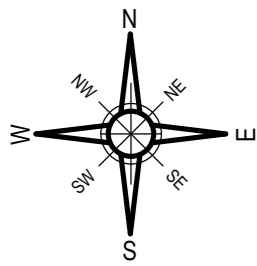

Blue dash line denotes extent of 2.3m high proposed sound barrier in Stage 1

Red dash line denotes separation of Stage 1 & Stage 2

TA denotes a turnaround area for vehicles in Stage 01 and will be converted to park and Lot 83 in Stage 02

Park 01 will be 6640 m2 once Stage 02 is complete

Subdivision Plan - Stage 1
1:1500 @ A3

Stage 1 Subdivision Plan
1:1500@ A3

Stage 1 - Subdivision Plan
Proposed Subdivision

Mobile: 0427 796 140
Email: brad@crtpc.com.au
www.cunningtonrossetownplanning.com.au



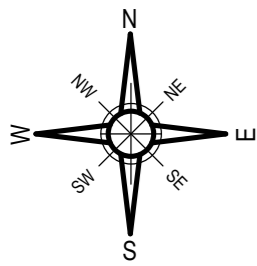

10m
22.5m
Lot Type 1 - 300m² - 449m²
(Lots 10, 11, 12, 16, 17, 20, 56, 61, 64, 71, 76, 79)

11m
22.5m
Lot Type 2 - 450m² - 599m²
(Lots 3, 4, 5, 8, 9, 13, 18, 22, 24, 25, 27, 28, 29, 30, 31, 32, 33, 35, 36, 37, 38, 39, 40, 41, 42, 47, 48, 49, 50, 51, 52, 53, 54, 55, 57, 58, 59, 60, 62, 63, 65, 66, 67, 68, 72, 73, 74, 75, 77, 78)

12m
22.5m
Lot Type 2a - 450m² - 599m² - (Corner Lots)
(Lots 6, 7, 15, 21, 23, 69, 70)

20m
24.5m
Lot Type 3 - 600m² +
(Lots 1, 2, 19, 26, 34, 43, 44, 45, 46, 80)

21m
24.5m
Lot Type 3a - 600m² + (Corner Lots)
(Lots 14)



Stage 1 - Building Envelope Plan
1:1500 @ A3

Stage 1 - Building Envelope Plan
Proposed Subdivision

Mobile: 0427 796 140
Email: brad@crtpc.com.au
www.cunningtonrossetownplanning.com.au



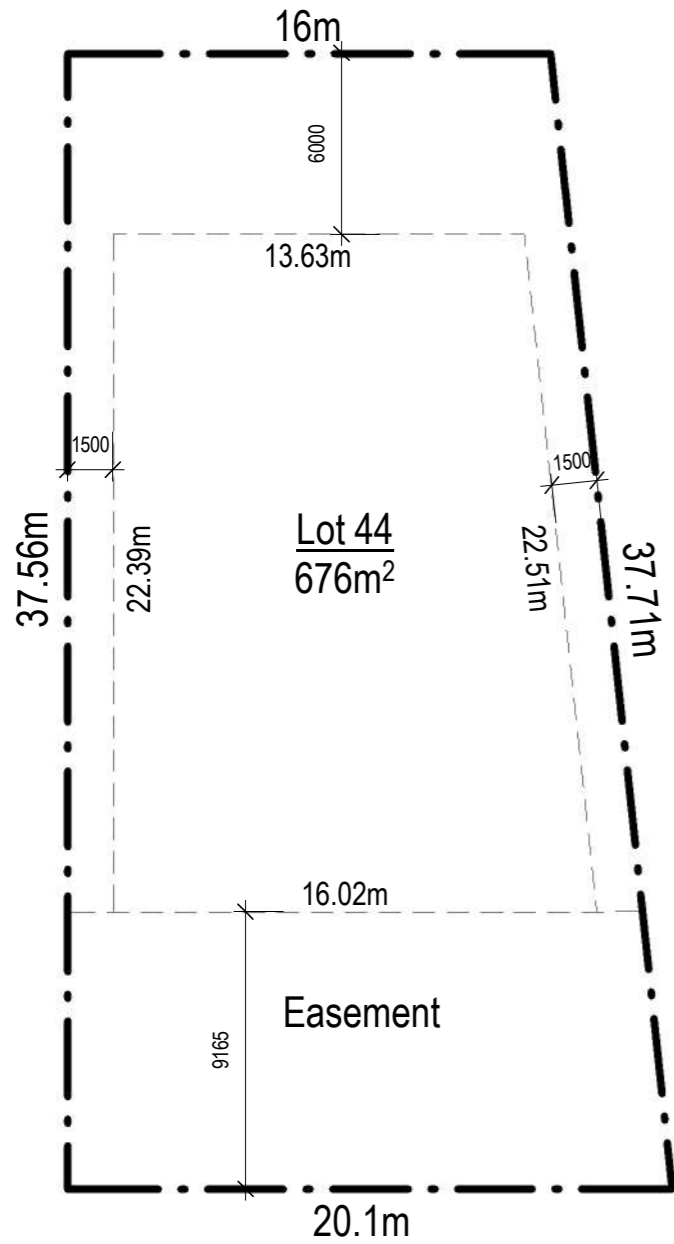

Lot 44 - Envelope Plan

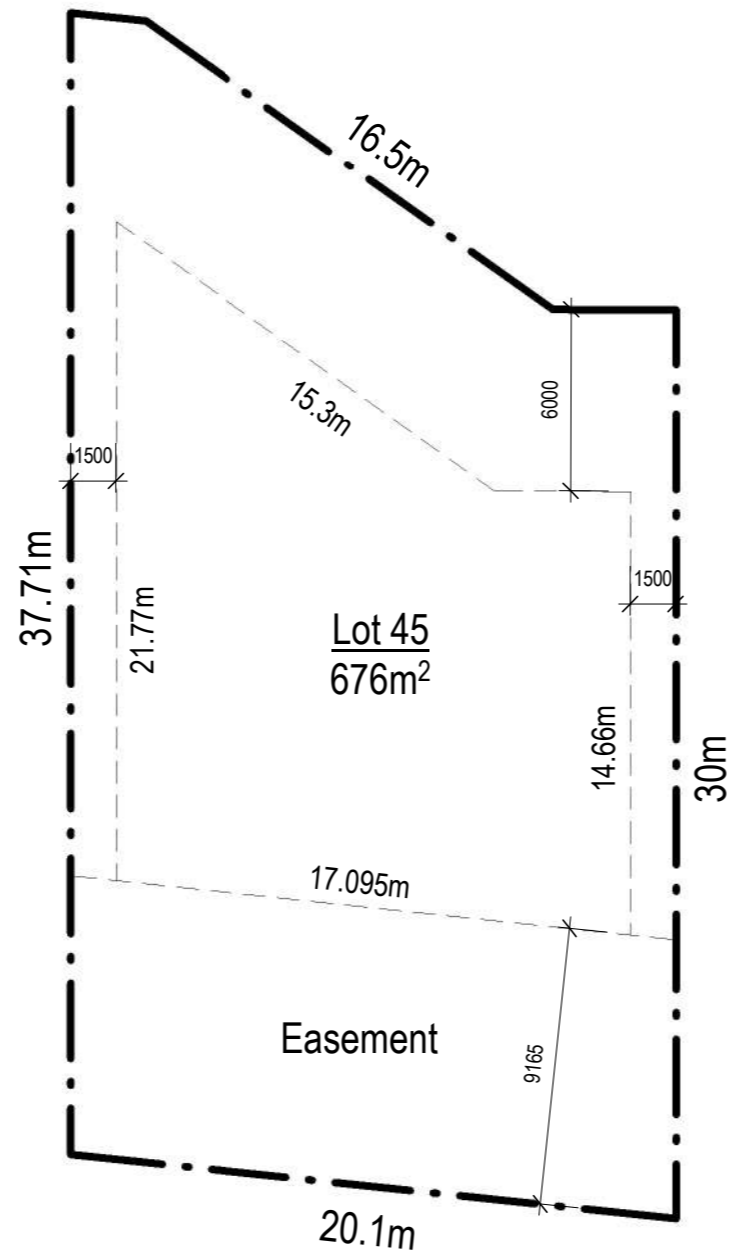

Lot 45 - Envelope Plan

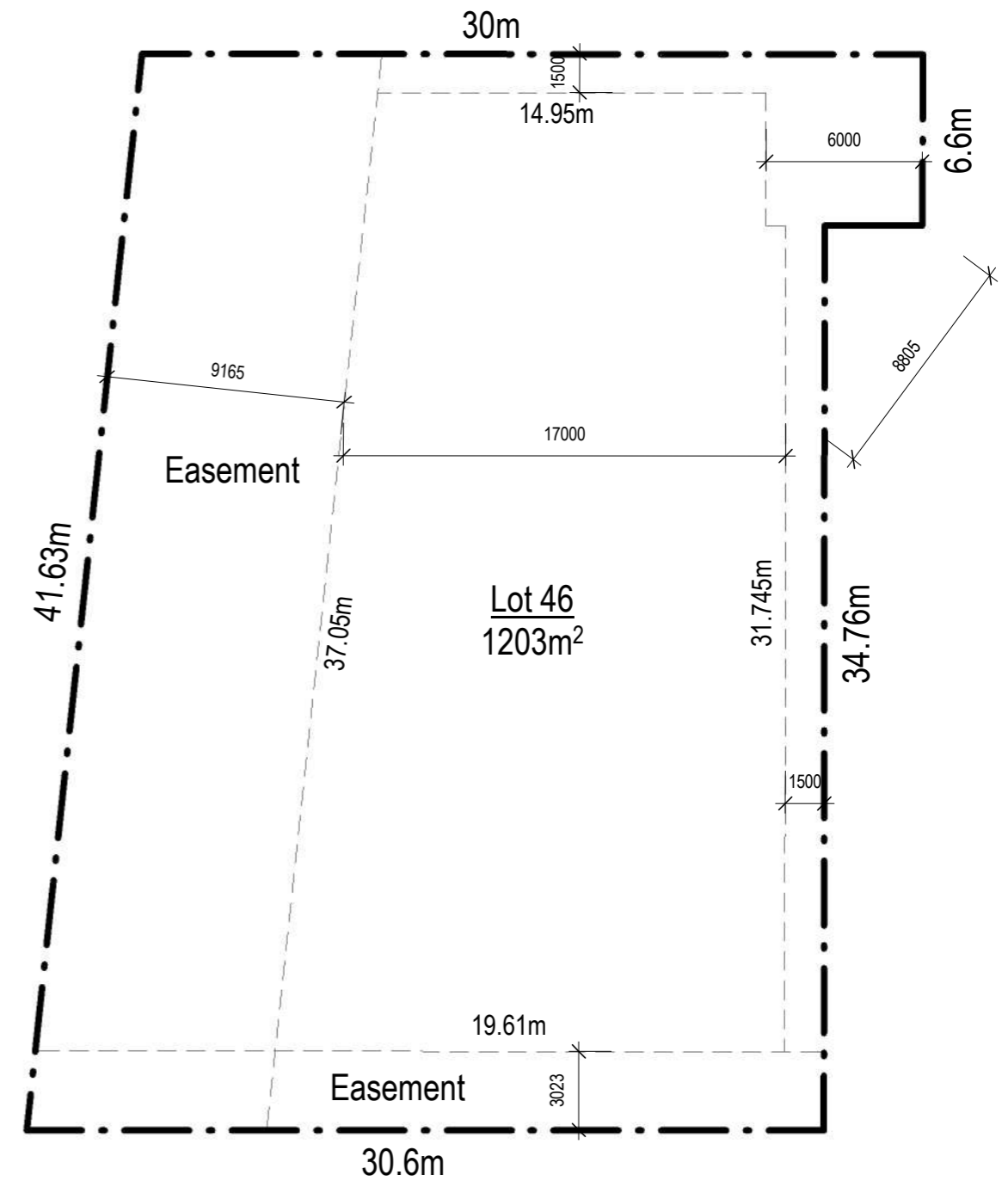

Lot 46 - Envelope Plan

Envelope Plans
Proposed Subdivision

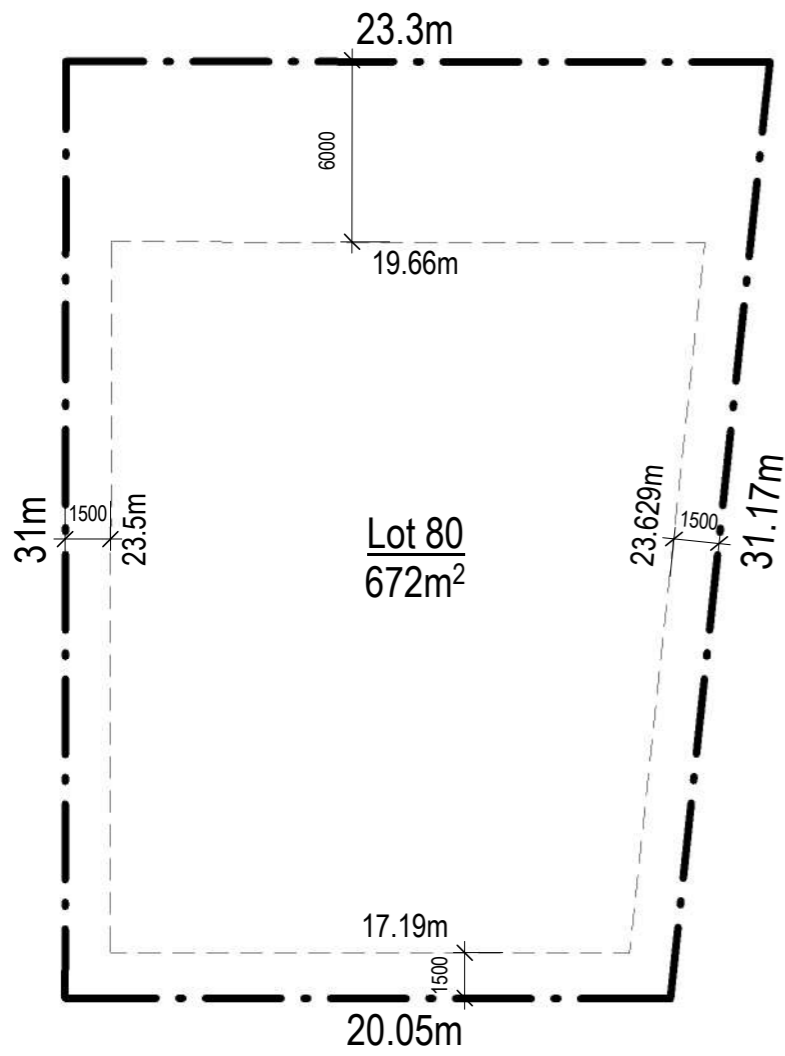

Lot 80 - Envelope Plan

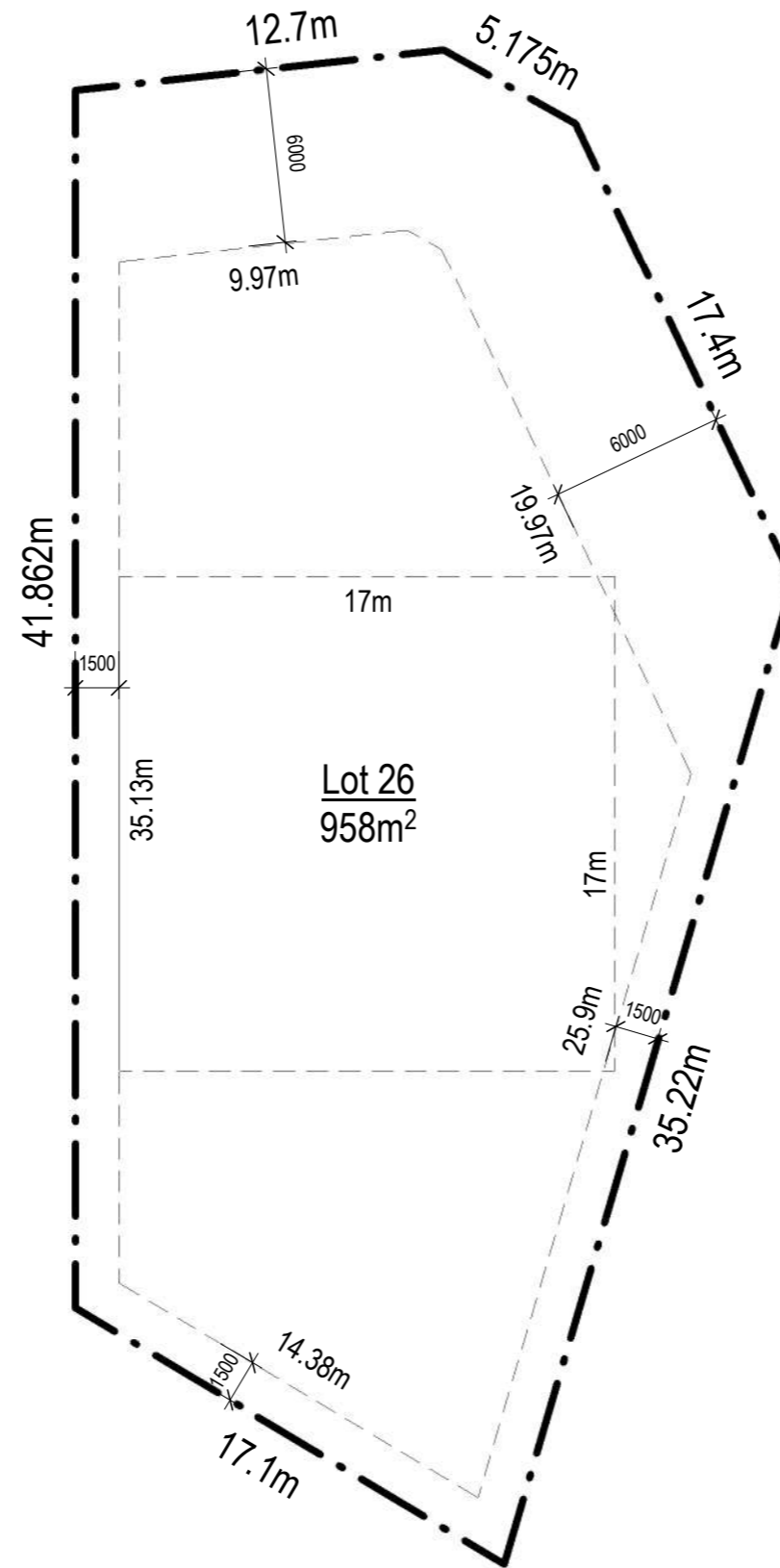

Lot 26 - Envelope Plan

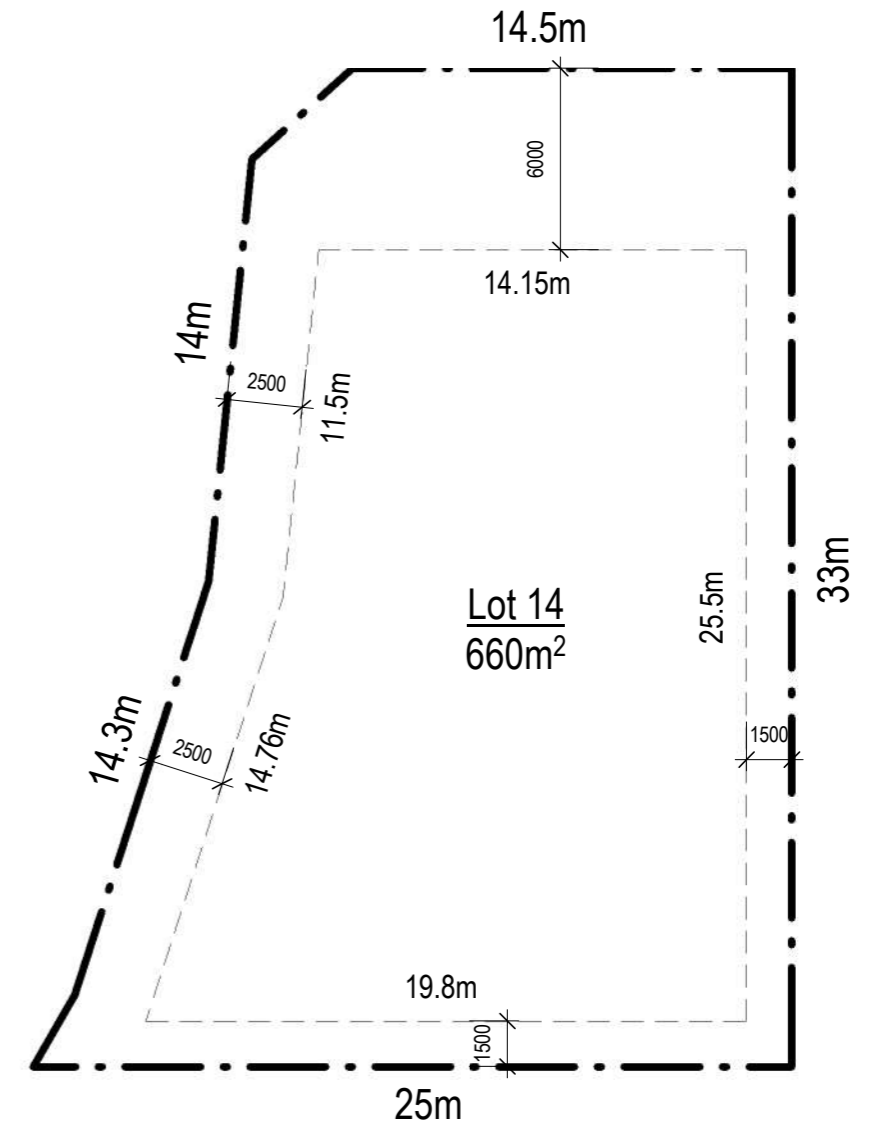

Lot 14 - Envelope Plan

Envelope Plans
Proposed Subdivision