

SHEET No.	SHEET NAME	REV.	ISSUED	REV. DATE
TP0.00	COVER PAGE	A	TOWN PLANNING	19/02/21
TP0.01	DEVELOPMENT SUMMARY & LEGEND	A	TOWN PLANNING	19/02/21
TP0.02	DESIGN RESPONSE WITH SITE PHOTOS	A	TOWN PLANNING	19/02/21
TP0.03	SITE OPPORTUNITIES & CONSTRAINTS	A	TOWN PLANNING	19/02/21
TP0.11	EXISTING SITE CONDITIONS	A	TOWN PLANNING	19/02/21
TP0.12	DEMOLITION PLAN	A	TOWN PLANNING	19/02/21
TP0.13	PROPOSED SITE PLAN	A	TOWN PLANNING	19/02/21
TP0.21	PERSPECTIVE IMAGES - SHEET 01	A	TOWN PLANNING	19/02/21
TP0.22	PERSPECTIVE IMAGES - SHEET 02	A	TOWN PLANNING	19/02/21
TP1.01	OVERALL PLAN - SEMI-BASEMENT	A	TOWN PLANNING	19/02/21
TP1.02	FLOOR PLAN - SEMI-BASEMENT - HOTEL - PART A	A	TOWN PLANNING	19/02/21
TP1.03	FLOOR PLAN - SEMI-BASEMENT - HOTEL - PART B	A	TOWN PLANNING	19/02/21
TP1.04	OVERALL PLAN - GROUND LEVEL	B	TOWN PLANNING	12/05/21
TP1.05	FLOOR PLAN - GROUND LEVEL - SERVICED APARTMENTS / FORESHORE VILLAS	A	TOWN PLANNING	19/02/21
TP1.06	FLOOR PLAN - GROUND LEVEL - HOTEL	A	TOWN PLANNING	19/02/21
TP1.07	FLOOR PLAN - GROUND LEVEL - GARDEN & LAGOON VILLAS - PART A	A	TOWN PLANNING	19/02/21
TP1.08	FLOOR PLAN - GROUND LEVEL - LAGOON VILLAS - PART B	A	TOWN PLANNING	19/02/21
TP1.09	OVERALL PLAN - LEVEL 01	B	TOWN PLANNING	12/05/21
TP1.10	FLOOR PLAN - LEVEL 01 - SERVICED APARTMENTS / ROOF PLAN - FORESHORE VILLAS	A	TOWN PLANNING	19/02/21
TP1.11	FLOOR PLAN - LEVEL 01 - HOTEL	A	TOWN PLANNING	19/02/21
TP1.12	ROOF PLAN - GARDEN & LAGOON VILLAS - PART A	A	TOWN PLANNING	19/02/21
TP1.13	ROOF PLAN - LAGOON VILLAS - PART B	A	TOWN PLANNING	19/02/21
TP1.14	OVERALL PLAN - LEVEL 02	B	TOWN PLANNING	12/05/21
TP1.15	FLOOR PLAN - LEVEL 02 - SERVICED APARTMENTS	A	TOWN PLANNING	19/02/21
TP1.16	FLOOR PLAN - LEVEL 02 - HOTEL	A	TOWN PLANNING	19/02/21
TP1.17	OVERALL PLAN - LEVEL 03	B	TOWN PLANNING	12/05/21
TP1.18	FLOOR PLAN - LEVEL 03 - SERVICED APARTMENTS	A	TOWN PLANNING	19/02/21
TP1.19	FLOOR PLAN - LEVEL 03 - HOTEL	A	TOWN PLANNING	19/02/21
TP1.20	OVERALL PLAN - LEVEL 04	B	TOWN PLANNING	12/05/21
TP1.21	FLOOR PLAN - LEVEL 04 - SERVICED APARTMENTS	A	TOWN PLANNING	19/02/21
TP1.22	FLOOR PLAN - LEVEL 04 - HOTEL	A	TOWN PLANNING	19/02/21
TP1.23	OVERALL PLAN - LEVEL 05	B	TOWN PLANNING	12/05/21
TP1.24	FLOOR PLAN - LEVEL 05 - SERVICED APARTMENTS	A	TOWN PLANNING	19/02/21
TP1.25	FLOOR PLAN - LEVEL 05 - HOTEL	A	TOWN PLANNING	19/02/21
TP1.26	OVERALL PLAN - ROOF	A	TOWN PLANNING	19/02/21
TP2.01	OVERALL ELEVATIONS - SERVICED APARTMENT / FORESHORE VILLAS	A	TOWN PLANNING	19/02/21
TP2.02	OVERALL ELEVATIONS - HOTEL	A	TOWN PLANNING	19/02/21
TP2.03	OVERALL ELEVATIONS - GARDEN VILLAS	A	TOWN PLANNING	19/02/21
TP2.04	OVERALL ELEVATIONS - LAGOON VILLAS	A	TOWN PLANNING	19/02/21
TP3.02	BUILDING SECTIONS - GARDEN & LAGOON VILLA	A	TOWN PLANNING	19/02/21
TP3.03	BUILDING SECTION - HOTEL / F&B BAR	A	TOWN PLANNING	19/02/21
TP4.01	PROPOSED SHADOW DIAGRAMS	A	TOWN PLANNING	19/02/21

# 257

LITTLE MINDIL - 25 GILRUTH AVENUE, THE GARDENS, DARWIN



**HACHEM ARCHITECTURE INTERIOR MARKETING**  
 HACHEM.COM.AU LEVEL 3, 2 DREWEYRY PLACE 188 WESTON STREET  
 INFO@HACHEM.COM.AU MELBOURNE 3000 BRUNSWICK EAST 3057  
 STUDIO +61 1300 734 560 VICTORIA, AUSTRALIA VICTORIA, AUSTRALIA

The information contained within this and accompanying documents is confidential and commercially sensitive. They are permitted only to be opened, read and used by the addressee. Verify all dimensions and levels on site prior to shop drawing or construction. Do not scale drawings. Figure dimensions must be used in preference to scaled dimensions. Notify Architect of any discrepancies.

REV.	DESCRIPTION	DATE
A	TOWN PLANNING SUBMISSION	19/02/21

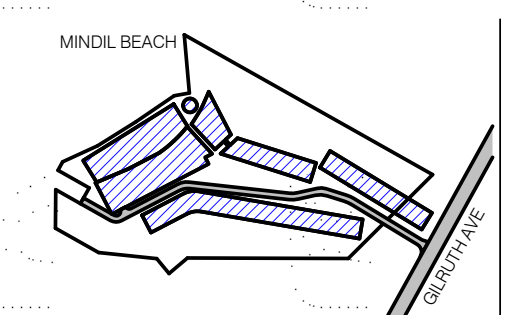

PROJECT LOCATION  
**25 GILRUTH AVENUE, THE GARDENS, DARWIN**

CLIENT  
**DAVID DO AWI**

DRAWING SCALE  
 SHEET SIZE  
 PROJECT NO

DRAWING DATE  
 CHECK  
 DRAWN



DRAWING TITLE  
**COVER PAGE**

PROJECT NAME  
**LITTLE MINDIL**

REVISION  
**A**

BUILDING / ATTRIBUTE  
**12°26'59" S  
 130°49'45" E**

DRAWING NO.  
**TP0.00**



**SITE AREA**

NAME	AREA	%
SITE AREA	51326 m <sup>2</sup>	100%

**DEVELOPMENT SUMMARY**

2 BEDROOM APARTMENTS	22
3 BEDROOM APARTMENTS	2
4 BEDROOM APARTMENTS	2
HOTEL ROOMS	149
2 BEDROOM GARDEN VILLAS	3
2 BEDROOM LAGOON VILLAS	16
3 BEDROOM FORESHORE VILLAS	7

GROUND	
2 BEDROOM GARDEN VILLAS	3
2 BEDROOM LAGOON VILLAS	16
3 BEDROOM FORESHORE VILLAS	7

LEVEL 01	
2 BEDROOM APARTMENTS	6
3 BEDROOM APARTMENTS	2

LEVEL 02	
2 BEDROOM APARTMENTS	4
3 BEDROOM APARTMENTS	10
4 BEDROOM APARTMENTS	1
HOTEL ROOMS	17

LEVEL 03	
2 BEDROOM APARTMENTS	4
HOTEL ROOMS	49

LEVEL 04	
2 BEDROOM APARTMENTS	4
3 BEDROOM APARTMENTS	10
4 BEDROOM APARTMENTS	1
HOTEL ROOMS	46

LEVEL 05	
2 BEDROOM APARTMENTS	4
HOTEL ROOMS	37

**HOTEL ROOMS SCHEDULE**

ROOM NO.	TYPE	ROOM	BALCONY	TOTAL
----------	------	------	---------	-------

2001	S1	68 m <sup>2</sup>	13 m <sup>2</sup>	80 m <sup>2</sup>
2002	S1	70 m <sup>2</sup>	13 m <sup>2</sup>	82 m <sup>2</sup>
2003	S1	72 m <sup>2</sup>	13 m <sup>2</sup>	85 m <sup>2</sup>
2004	S5	61 m <sup>2</sup>	13 m <sup>2</sup>	74 m <sup>2</sup>
2005	K2	33 m <sup>2</sup>	13 m <sup>2</sup>	46 m <sup>2</sup>
2006	S6	69 m <sup>2</sup>	22 m <sup>2</sup>	90 m <sup>2</sup>
2007	K2	34 m <sup>2</sup>	0 m <sup>2</sup>	34 m <sup>2</sup>
2008	K2	34 m <sup>2</sup>	0 m <sup>2</sup>	34 m <sup>2</sup>
2009	K2	34 m <sup>2</sup>	0 m <sup>2</sup>	34 m <sup>2</sup>
2010	K2	34 m <sup>2</sup>	0 m <sup>2</sup>	34 m <sup>2</sup>
2011	K3	27 m <sup>2</sup>	0 m <sup>2</sup>	27 m <sup>2</sup>
		536 m <sup>2</sup>	85 m <sup>2</sup>	622 m <sup>2</sup>

**LEVEL 03**

3001	S2	61 m <sup>2</sup>	13 m <sup>2</sup>	74 m <sup>2</sup>
3002	S2	62 m <sup>2</sup>	13 m <sup>2</sup>	75 m <sup>2</sup>
3003	S2	63 m <sup>2</sup>	13 m <sup>2</sup>	76 m <sup>2</sup>
3004	S7	51 m <sup>2</sup>	13 m <sup>2</sup>	63 m <sup>2</sup>
3005	K7	32 m <sup>2</sup>	13 m <sup>2</sup>	44 m <sup>2</sup>
3006	K6	37 m <sup>2</sup>	20 m <sup>2</sup>	57 m <sup>2</sup>
3007	K2	34 m <sup>2</sup>	0 m <sup>2</sup>	34 m <sup>2</sup>
3008	K2	34 m <sup>2</sup>	0 m <sup>2</sup>	34 m <sup>2</sup>
3009	K2	34 m <sup>2</sup>	0 m <sup>2</sup>	34 m <sup>2</sup>
3010	K2	34 m <sup>2</sup>	0 m <sup>2</sup>	34 m <sup>2</sup>
3011	K3	27 m <sup>2</sup>	0 m <sup>2</sup>	27 m <sup>2</sup>
3012	K4	38 m <sup>2</sup>	0 m <sup>2</sup>	38 m <sup>2</sup>
3013	S4	51 m <sup>2</sup>	0 m <sup>2</sup>	51 m <sup>2</sup>
3014	K1	38 m <sup>2</sup>	0 m <sup>2</sup>	38 m <sup>2</sup>
3015	K1	38 m <sup>2</sup>	0 m <sup>2</sup>	38 m <sup>2</sup>
3016	K1	38 m <sup>2</sup>	0 m <sup>2</sup>	38 m <sup>2</sup>
3017	K1	38 m <sup>2</sup>	0 m <sup>2</sup>	38 m <sup>2</sup>
3018	K1	38 m <sup>2</sup>	0 m <sup>2</sup>	38 m <sup>2</sup>
3019	K1	38 m <sup>2</sup>	0 m <sup>2</sup>	38 m <sup>2</sup>
3020	K1	38 m <sup>2</sup>	0 m <sup>2</sup>	38 m <sup>2</sup>
3021	K1	38 m <sup>2</sup>	0 m <sup>2</sup>	38 m <sup>2</sup>
3022	K1	38 m <sup>2</sup>	0 m <sup>2</sup>	38 m <sup>2</sup>
3023	K1	38 m <sup>2</sup>	0 m <sup>2</sup>	38 m <sup>2</sup>
3024	K1	38 m <sup>2</sup>	0 m <sup>2</sup>	38 m <sup>2</sup>
3025	K1	38 m <sup>2</sup>	0 m <sup>2</sup>	38 m <sup>2</sup>
3026	K1	38 m <sup>2</sup>	0 m <sup>2</sup>	38 m <sup>2</sup>
3027	K1	38 m <sup>2</sup>	0 m <sup>2</sup>	38 m <sup>2</sup>
3028	K1	38 m <sup>2</sup>	0 m <sup>2</sup>	38 m <sup>2</sup>
3029	K1	38 m <sup>2</sup>	0 m <sup>2</sup>	38 m <sup>2</sup>
3030	K5	33 m <sup>2</sup>	0 m <sup>2</sup>	33 m <sup>2</sup>
3031	K1	38 m <sup>2</sup>	0 m <sup>2</sup>	38 m <sup>2</sup>
3032	K1	38 m <sup>2</sup>	0 m <sup>2</sup>	38 m <sup>2</sup>
3033	K1	38 m <sup>2</sup>	0 m <sup>2</sup>	38 m <sup>2</sup>
3034	K1	38 m <sup>2</sup>	0 m <sup>2</sup>	38 m <sup>2</sup>
3035	K1	38 m <sup>2</sup>	0 m <sup>2</sup>	38 m <sup>2</sup>
3036	K1	38 m <sup>2</sup>	0 m <sup>2</sup>	38 m <sup>2</sup>
3037	K1	38 m <sup>2</sup>	0 m <sup>2</sup>	38 m <sup>2</sup>
3038	K1	38 m <sup>2</sup>	0 m <sup>2</sup>	38 m <sup>2</sup>
3039	K1	37 m <sup>2</sup>	0 m <sup>2</sup>	37 m <sup>2</sup>
3040	K1	38 m <sup>2</sup>	0 m <sup>2</sup>	38 m <sup>2</sup>
3041	K1	38 m <sup>2</sup>	0 m <sup>2</sup>	38 m <sup>2</sup>
3042	K12	38 m <sup>2</sup>	0 m <sup>2</sup>	38 m <sup>2</sup>
3043	K1	38 m <sup>2</sup>	0 m <sup>2</sup>	38 m <sup>2</sup>
		1682 m <sup>2</sup>	83 m <sup>2</sup>	1766 m <sup>2</sup>

**LEVEL 04**

4001	S3	52 m <sup>2</sup>	13 m <sup>2</sup>	64 m <sup>2</sup>
4002	S3	51 m <sup>2</sup>	13 m <sup>2</sup>	64 m <sup>2</sup>
4003	S3	52 m <sup>2</sup>	13 m <sup>2</sup>	64 m <sup>2</sup>
4004	K8	25 m <sup>2</sup>	13 m <sup>2</sup>	38 m <sup>2</sup>
4005	K9	32 m <sup>2</sup>	13 m <sup>2</sup>	44 m <sup>2</sup>
4006	K10	44 m <sup>2</sup>	17 m <sup>2</sup>	61 m <sup>2</sup>
4007	K2	34 m <sup>2</sup>	0 m <sup>2</sup>	34 m <sup>2</sup>
4008	K2	34 m <sup>2</sup>	0 m <sup>2</sup>	34 m <sup>2</sup>
4009	K2	34 m <sup>2</sup>	0 m <sup>2</sup>	34 m <sup>2</sup>
4010	K3	27 m <sup>2</sup>	0 m <sup>2</sup>	27 m <sup>2</sup>
4011	K4	39 m <sup>2</sup>	0 m <sup>2</sup>	39 m <sup>2</sup>

**HACHEM ARCHITECTURE INTERIOR MARKETING**

HACHEM.COM.AU LEVEL 3, 2 DREWRY PLACE 183 WESTON STREET  
 INFO@HACHEM.COM.AU MELBOURNE 3000 BRUNSWICK EAST 3057  
 STUDIO +61 1300 734 560 VICTORIA, AUSTRALIA VICTORIA, AUSTRALIA

The information contained within this and accompanying this document is confidential and commercially sensitive. They are permitted only to be opened, read and used by the addressee. Verify all dimensions and levels on site prior to shop drawing or construction. Do not scale drawings. Figure dimensions must be used in preference to scaled dimensions. Notify Architect of any discrepancies.

**AREA ANALYSIS**

DEPARTMENT	AREA
SEMI-BASEMENT	3 m <sup>2</sup>
HOTEL	
ADMIN OFFICES	214 m <sup>2</sup>
BOH & SUPPORT AREAS	1768 m <sup>2</sup>
EXTERNAL AREAS & PARKING	5496 m <sup>2</sup>
PUBLIC AREAS	40 m <sup>2</sup>
SERVICES	8 m <sup>2</sup>
VERTICAL CIRCULATION	81 m <sup>2</sup>
	7908 m <sup>2</sup>

GROUND	
EXTERNAL AREAS & PARKING	2767 m <sup>2</sup>
SERVICES	297 m <sup>2</sup>
VERTICAL CIRCULATION	38 m <sup>2</sup>

HOTEL	
BOH & SUPPORT AREAS	562 m <sup>2</sup>
EXTERNAL AREAS & PARKING	811 m <sup>2</sup>
GARDEN VILLA	13 m <sup>2</sup>
LAGOON VILLA	2408 m <sup>2</sup>
PUBLIC AREAS	38 m <sup>2</sup>
RECREATIONAL	105 m <sup>2</sup>
RESTAURANT & BARS / SUPPORT	213 m <sup>2</sup>
RETAIL	9 m <sup>2</sup>
SERVICES	13 m <sup>2</sup>

VILLA	
FORESHORE VILLA	3813 m <sup>2</sup>
GARDEN VILLA	295 m <sup>2</sup>
LAGOON VILLA	1631 m <sup>2</sup>
SERVICES	446 m <sup>2</sup>
	13471 m <sup>2</sup>

LEVEL 01	
APARTMENT	
APARTMENT FLOORS	1668 m <sup>2</sup>
BOH & SUPPORT AREAS	311 m <sup>2</sup>
RECREATIONAL	399 m <sup>2</sup>
SERVICES	111 m <sup>2</sup>

HOTEL	
ADMIN OFFICES	16 m <sup>2</sup>
BOH & SUPPORT AREAS	143 m <sup>2</sup>

**HOTEL ROOMS SCHEDULE**

ROOM NO.	TYPE	ROOM	BALCONY	TOTAL
----------	------	------	---------	-------

4012	S4	52 m <sup>2</sup>	0 m <sup>2</sup>	52 m <sup>2</sup>
4013	K1	38 m <sup>2</sup>	0 m <sup>2</sup>	38 m <sup>2</sup>
4014	K1	38 m <sup>2</sup>	0 m <sup>2</sup>	38 m <sup>2</sup>
4015	K1	38 m <sup>2</sup>	0 m <sup>2</sup>	38 m <sup>2</sup>
4016	K1	38 m <sup>2</sup>	0 m <sup>2</sup>	38 m <sup>2</sup>
4017	K1	38 m <sup>2</sup>	0 m <sup>2</sup>	38 m <sup>2</sup>
4018	K1	38 m <sup>2</sup>	0 m <sup>2</sup>	38 m <sup>2</sup>
4019	K1	38 m <sup>2</sup>	0 m <sup>2</sup>	38 m <sup>2</sup>
4020	K1	38 m <sup>2</sup>	0 m <sup>2</sup>	38 m <sup>2</sup>
4021	K1	38 m <sup>2</sup>	0 m <sup>2</sup>	38 m <sup>2</sup>
4022	K1	38 m <sup>2</sup>	0 m <sup>2</sup>	38 m <sup>2</sup>
4023	K1	38 m <sup>2</sup>	0 m <sup>2</sup>	38 m <sup>2</sup>
4024	K1	38 m <sup>2</sup>	0 m <sup>2</sup>	38 m <sup>2</sup>
4025	K1	38 m <sup>2</sup>	0 m <sup>2</sup>	38 m <sup>2</sup>
4026	K1	38 m <sup>2</sup>	0 m <sup>2</sup>	38 m <sup>2</sup>
4027	K1	38 m <sup>2</sup>	0 m <sup>2</sup>	38 m <sup>2</sup>
4028	K1	38 m <sup>2</sup>	0 m <sup>2</sup>	38 m <sup>2</sup>
4029	K5	33 m <sup>2</sup>	0 m <sup>2</sup>	33 m <sup>2</sup>
4030	K1	38 m <sup>2</sup>	0 m <sup>2</sup>	38 m <sup>2</sup>
4031	K1	38 m <sup>2</sup>	0 m <sup>2</sup>	38 m <sup>2</sup>
4032	K1	38 m <sup>2</sup>	0 m <sup>2</sup>	38 m <sup>2</sup>
4033	K1	38 m <sup>2</sup>	0 m <sup>2</sup>	38 m <sup>2</sup>
4034	K1	38 m <sup>2</sup>	0 m <sup>2</sup>	38 m <sup>2</sup>
4035	K1	38 m <sup>2</sup>	0 m <sup>2</sup>	38 m <sup>2</sup>
4036	K1	38 m <sup>2</sup>	0 m <sup>2</sup>	38 m <sup>2</sup>
4037	K1	38 m <sup>2</sup>	0 m <sup>2</sup>	38 m <sup>2</sup>
4038	K1	38 m <sup>2</sup>	0 m <sup>2</sup>	38 m <sup>2</sup>
4039	K12	38 m <sup>2</sup>	0 m <sup>2</sup>	38 m <sup>2</sup>
4040	K1	38 m <sup>2</sup>	0 m <sup>2</sup>	38 m <sup>2</sup>
		1525 m <sup>2</sup>	81 m <sup>2</sup>	1606 m <sup>2</sup>

**LEVEL 05**

5001	K11	42 m <sup>2</sup>	13 m <sup>2</sup>	55 m <sup>2</sup>
5002	K2	36 m <sup>2</sup>	13 m <sup>2</sup>	49 m <sup>2</sup>
5003	K2	36 m <sup>2</sup>	13 m <sup>2</sup>	49 m <sup>2</sup>
5004	K2	36 m <sup>2</sup>	13 m <sup>2</sup>	49 m <sup>2</sup>
5005	K2	36 m <sup>2</sup>	13 m <sup>2</sup>	49 m <sup>2</sup>
5006	S6	45 m <sup>2</sup>	15 m <sup>2</sup>	60 m <sup>2</sup>
5007	K2	34 m <sup>2</sup>	0 m <sup>2</sup>	34 m <sup>2</sup>
5008	K2	34 m <sup>2</sup>	0 m <sup>2</sup>	34 m <sup>2</sup>
5009	K3	27 m <sup>2</sup>	0 m <sup>2</sup>	27 m <sup>2</sup>
5010	K4	39 m <sup>2</sup>	0 m <sup>2</sup>	39 m <sup>2</sup>
5011	S4	51 m <sup>2</sup>	0 m <sup>2</sup>	51 m <sup>2</sup>
5012	K2	38 m <sup>2</sup>	0 m <sup>2</sup>	38 m <sup>2</sup>
5013	K2	38 m <sup>2</sup>	0 m <sup>2</sup>	38 m <sup>2</sup>
5014	K2	38 m <sup>2</sup>	0 m <sup>2</sup>	38 m <sup>2</sup>
5015	K2	38 m <sup>2</sup>	0 m <sup>2</sup>	38 m <sup>2</sup>
5016	K2	38 m <sup>2</sup>	0 m <sup>2</sup>	38 m <sup>2</sup>
5017	K2	38 m <sup>2</sup>	0 m <sup>2</sup>	38 m <sup>2</sup>
5018	K2	38 m <sup>2</sup>	0 m <sup>2</sup>	38 m <sup>2</sup>
5019	K2	38 m <sup>2</sup>	0 m <sup>2</sup>	38 m <sup>2</sup>
5020	K2	38 m <sup>2</sup>	0 m <sup>2</sup>	38 m <sup>2</sup>
5021	K2	38 m <sup>2</sup>	0 m <sup>2</sup>	38 m <sup>2</sup>
5022	K2	38 m <sup>2</sup>	0 m <sup>2</sup>	38 m <sup>2</sup>
5023	K2	38 m <sup>2</sup>	0 m <sup>2</sup>	38 m <sup>2</sup>
5024	K2	38 m <sup>2</sup>	0 m <sup>2</sup>	38 m <sup>2</sup>
5025	K2	38 m <sup>2</sup>	0 m <sup>2</sup>	38 m <sup>2</sup>
5026	K2	38 m <sup>2</sup>	0 m <sup>2</sup>	38 m <sup>2</sup>
5027	K2	38 m <sup>2</sup>	0 m <sup>2</sup>	38 m <sup>2</sup>





HACHEM ARCHITECTURE INTERIOR MARKETING  
 HACHEM.COM.AU LEVEL 3, 2 DREWERY PLACE 183 WESTON STREET  
 INFO@HACHEM.COM.AU MELBOURNE 3000 BRUNSWICK EAST 3067  
 STUDIO +61 1300 734 560 VICTORIA, AUSTRALIA VICTORIA, AUSTRALIA

The information contained within this and accompanying this document is confidential and commercially sensitive. They are permitted only to be opened, read and used by the addressee. Verify all dimensions and levels on site prior to shop drawing or construction. Do not scale drawings. Figure dimensions must be used in preference to scaled dimensions. Notify Architect of any discrepancies.

REV.	DESCRIPTION	DATE
A	TOWN PLANNING SUBMISSION	19/02/21

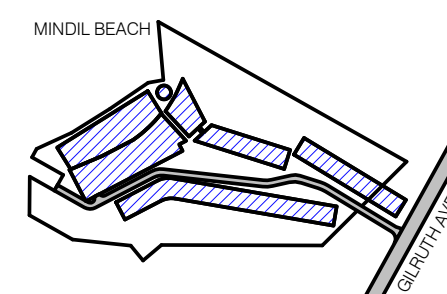
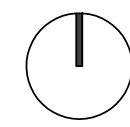

PROJECT LOCATION  
 25 GILRUTH AVENUE,  
 THE GARDENS, DARWIN

CLIENT  
 DAVID DO AWI

DRAWING SCALE SHEET SIZE PROJECT NO  
 A1 257

DRAWING DATE CHECK DRAWN  
 19/02/21 EP KS



DRAWING TITLE  
 DESIGN RESPONSE WITH SITE  
 PHOTOS

PROJECT NAME  
 LITTLE MINDIL

REVISION BUILDING / ATTRIBUTE  
 A 12°26'59" S  
 130°49'45" E

DRAWING NO.

TOWN PLANNING

TP0.02



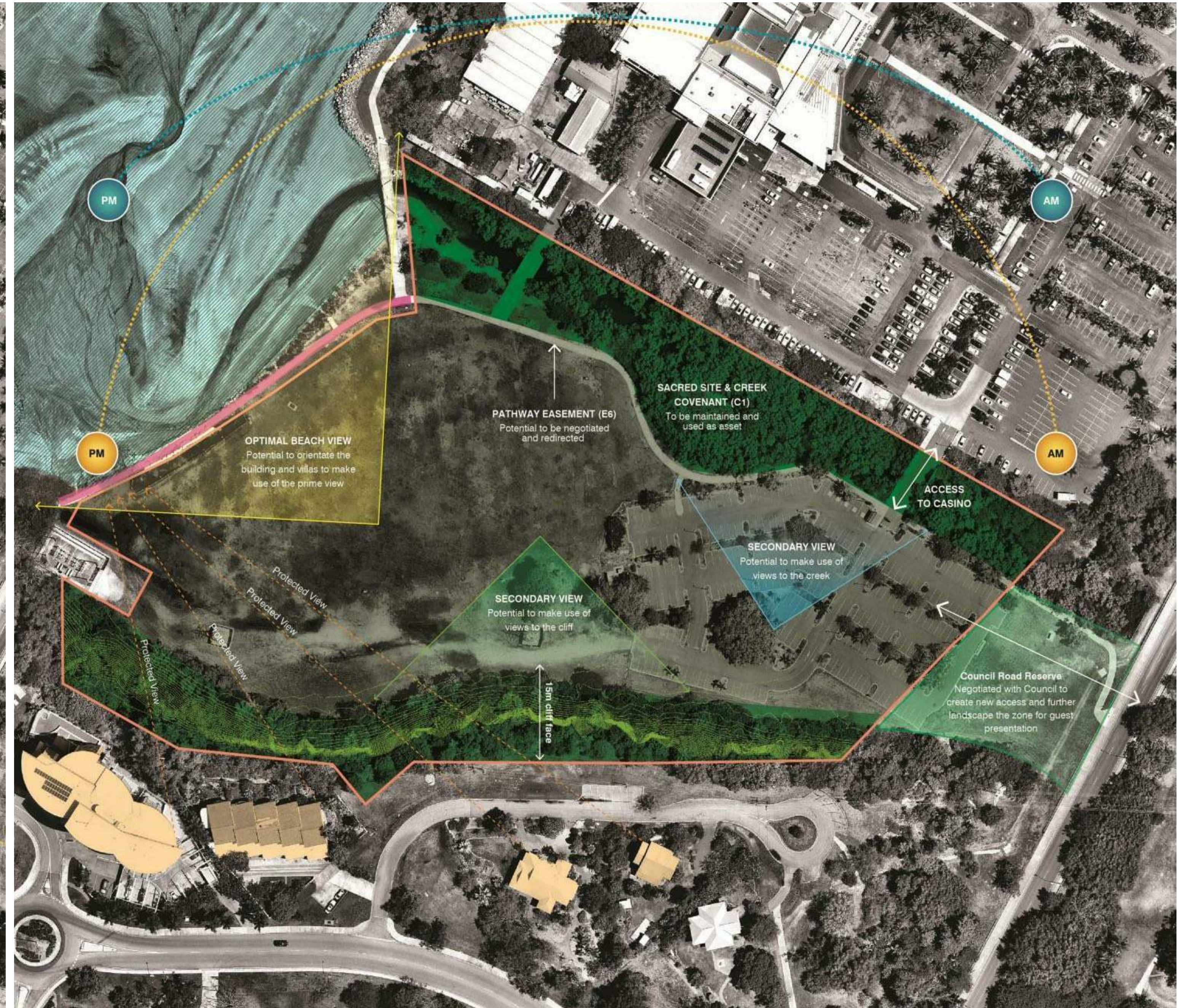
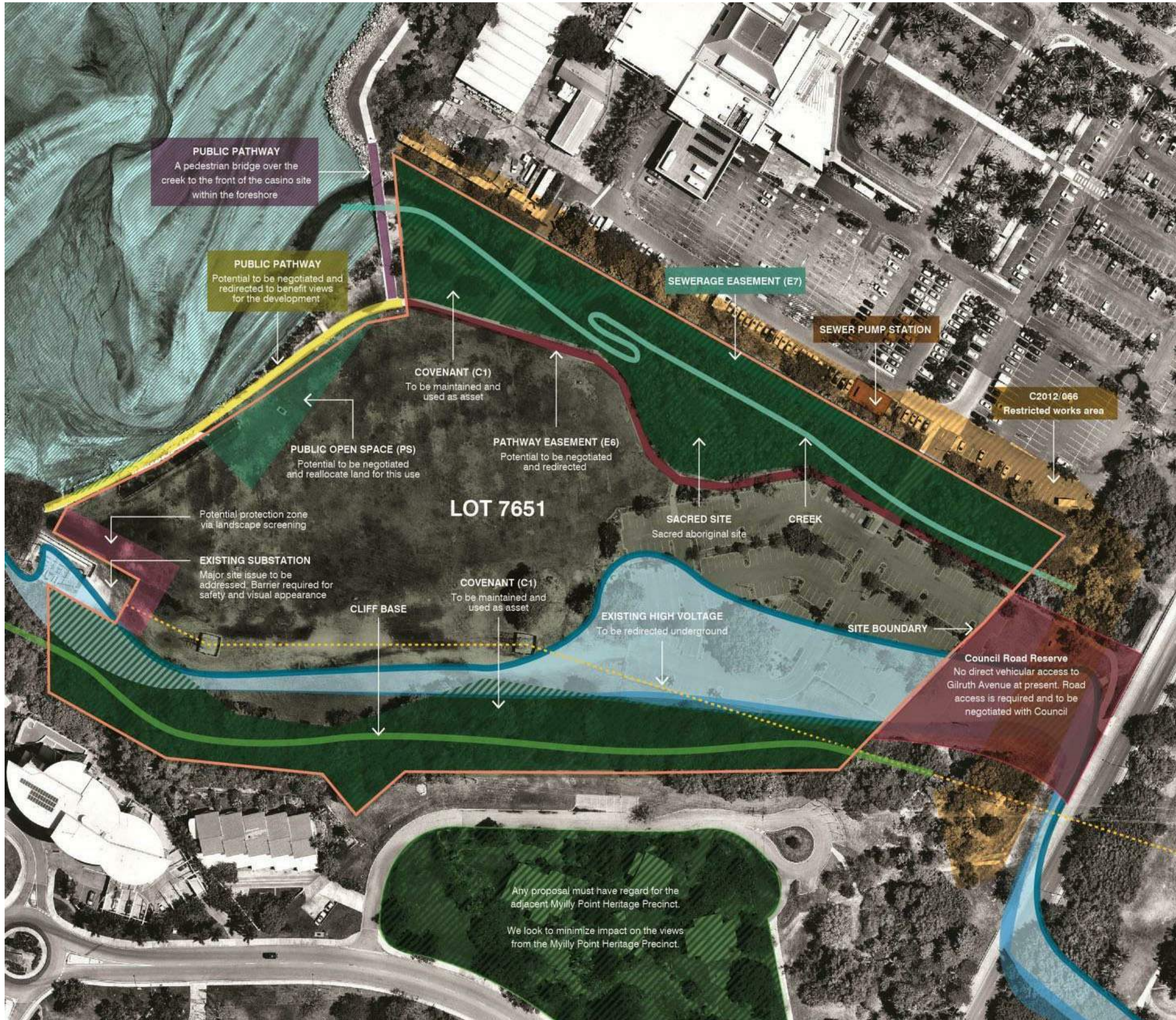

HACHEM ARCHITECTURE INTERIOR MARKETING

HACHEM.COM.AU LEVEL 3, 2 DREWERY PLACE 188 WESTON STREET  
 INFO@HACHEM.COM.AU MELBOURNE 3000 BRUNSWICK EAST 3067  
 STUDIO +61 1300 734 560 VICTORIA, AUSTRALIA VICTORIA, AUSTRALIA

The information contained within this and accompanying documents is confidential and commercially sensitive. They are permitted only to be opened, read and used by the addressee. Verify all dimensions and levels on site prior to shop drawing or construction. Do not scale drawings. Figure dimensions must be used in preference to scaled dimensions. Notify Architect of any discrepancies.

REV.	DESCRIPTION	DATE
A	TOWN PLANNING SUBMISSION	19/02/21

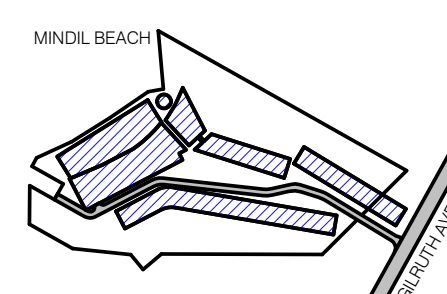
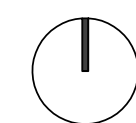

PROJECT LOCATION  
 25 GILRUTH AVENUE,  
 THE GARDENS, DARWIN

CLIENT  
 DAVID DO AWI

DRAWING SCALE  
 SHEET SIZE  
 PROJECT NO

DRAWING DATE  
 CHECK  
 DRAWN



DRAWING TITLE  
 SITE OPPORTUNITIES &  
 CONSTRAINTS

PROJECT NAME  
 LITTLE MINDIL

REVISION  
 BUILDING / ATTRIBUTE

DRAWING NO.

TOWN PLANNING

12°26'59" S  
 130°49'45" E

**TP0.03**



**EASEMENT LEGEND**

- (A) = EASEMENT (SEWERAGE) BENEFIT TO THE POWER & WATER CORPORATION.
- (B) = EASEMENT (ELECTRICITY SUPPLY) BENEFIT TO THE POWER & WATER CORPORATION.
- (C) = EASEMENT (ELECTRONIC COMMUNICATIONS SUPPLY) BENEFIT TO THE POWER & WATER CORPORATION.
- (D) = EASEMENT (RIGHT OF WAY) BENEFIT TO THE POWER & WATER CORPORATION.

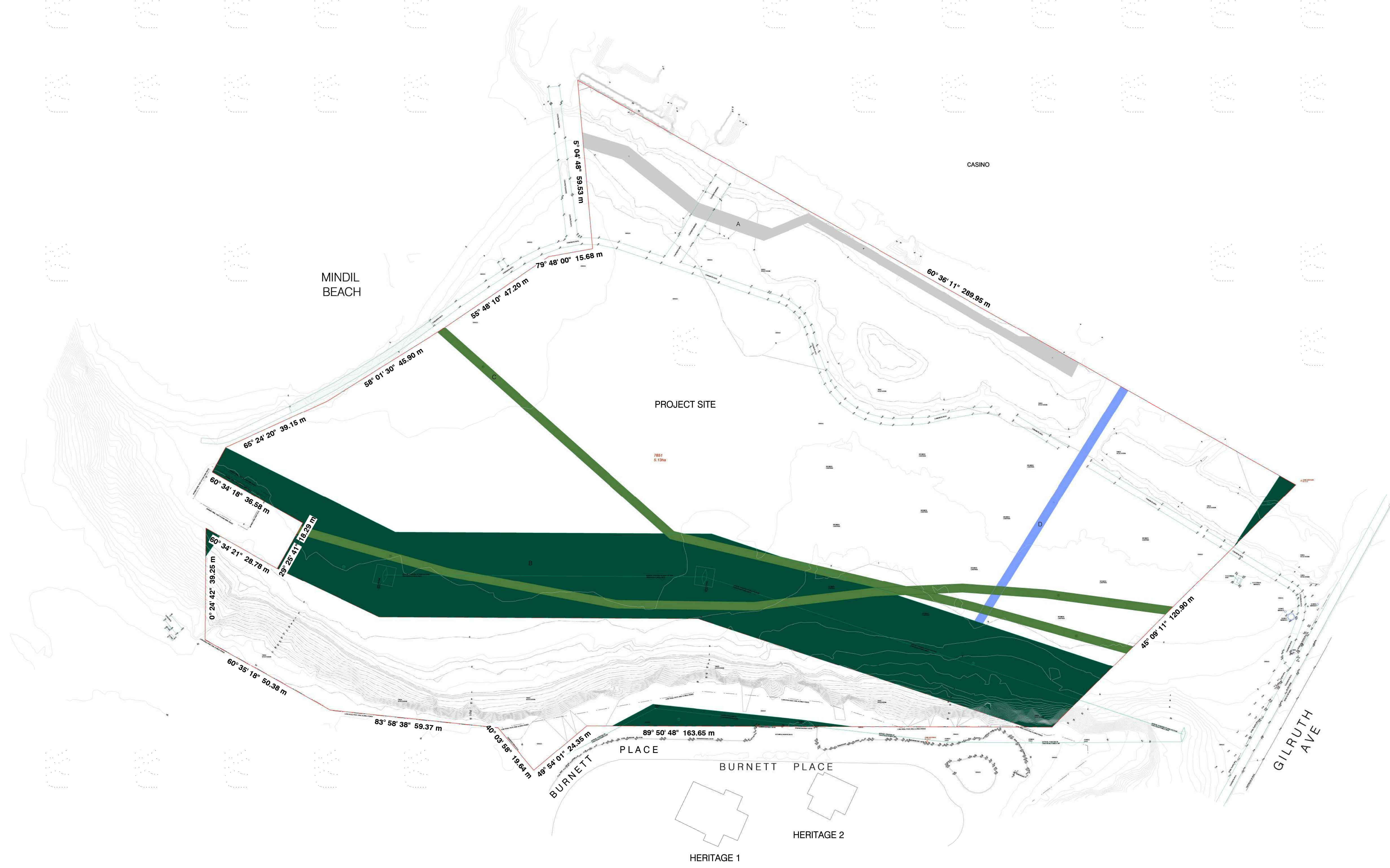

1 SITE PLAN - EXISTING  
1 : 750

**HACHEM ARCHITECTURE INTERIOR MARKETING**  
 HACHEM.COM.AU LEVEL 3, 2 DREWERY PLACE 183 WESTON STREET  
 INFO@HACHEM.COM.AU MELBOURNE 3000 BRUNSWICK EAST 3067  
 STUDIO +61 1300 734 560 VICTORIA, AUSTRALIA VICTORIA, AUSTRALIA

The information contained within this and accompanying this document is confidential and commercially sensitive. They are permitted only to be opened, read and used by the addressee. Verify all dimensions and levels on site prior to shop drawing or construction. Do not scale drawings. Figure dimensions must be used in preference to scaled dimensions. Notify Architect of any discrepancies.

REV.	DESCRIPTION	DATE
A	TOWN PLANNING SUBMISSION	19/02/21

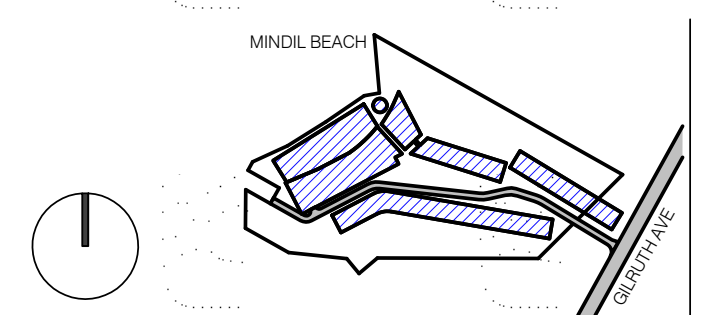

PROJECT LOCATION  
 25 GILRUTH AVENUE,  
 THE GARDENS, DARWIN

CLIENT  
 DAVID DO AWI

DRAWING SCALE  
 As indicated

DRAWING DATE  
 19/02/21

SHEET SIZE  
 A1

CHECK  
 EP

PROJECT NO  
 257

DRAWN  
 KS



DRAWING TITLE  
 EXISTING SITE CONDITIONS

PROJECT NAME  
 LITTLE MINDIL

REVISION  
**A**

BUILDING / ATTRIBUTE  
 12°26'59" S  
 130°49'45" E

DRAWING NO.  
**TP0.11**

TOWN PLANNING



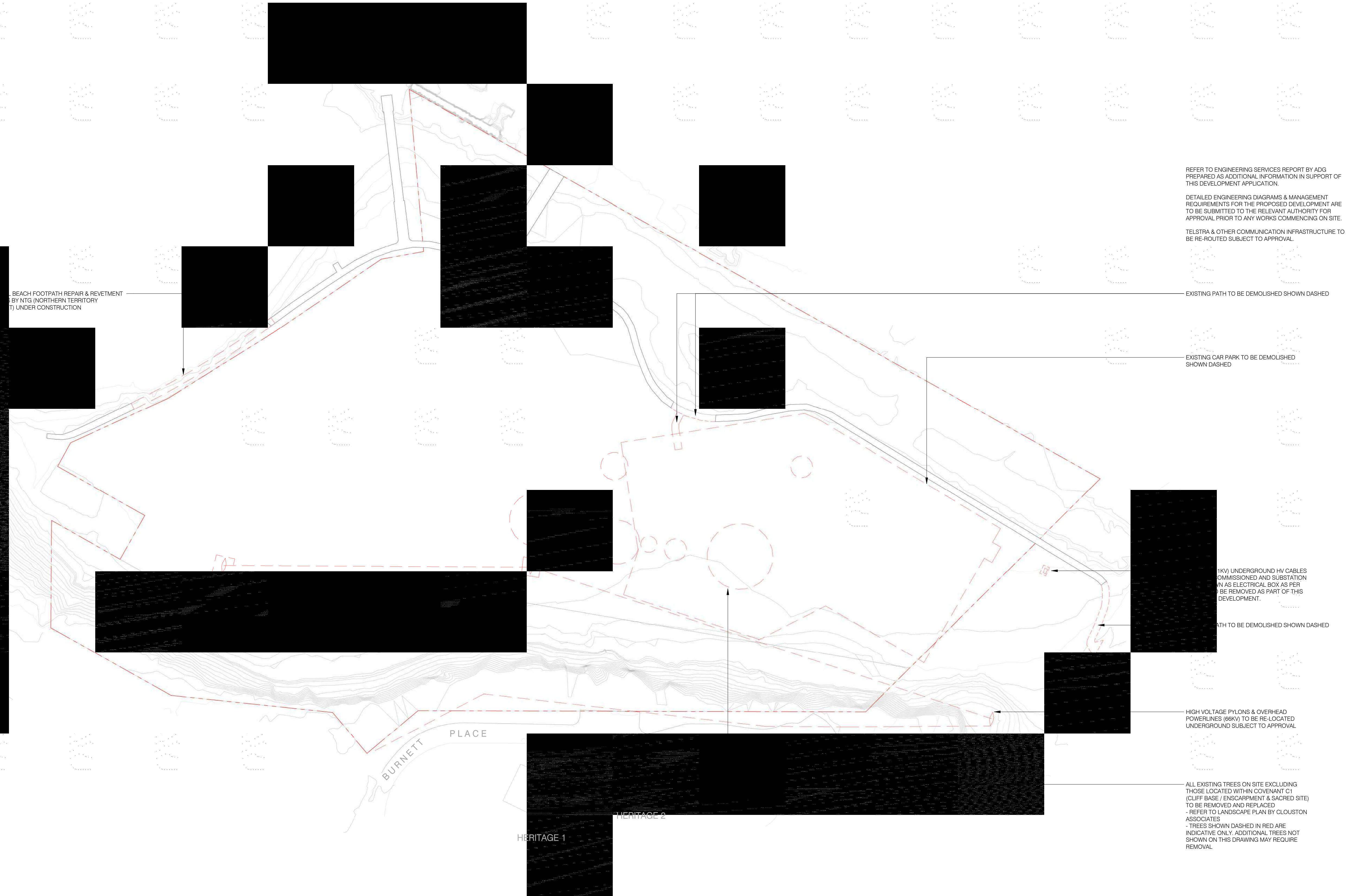

BEACH FOOTPATH REPAIR & REVETMENT BY NTG (NORTHERN TERRITORY) UNDER CONSTRUCTION

REFER TO ENGINEERING SERVICES REPORT BY ADG PREPARED AS ADDITIONAL INFORMATION IN SUPPORT OF THIS DEVELOPMENT APPLICATION.

DETAILED ENGINEERING DIAGRAMS & MANAGEMENT REQUIREMENTS FOR THE PROPOSED DEVELOPMENT ARE TO BE SUBMITTED TO THE RELEVANT AUTHORITY FOR APPROVAL PRIOR TO ANY WORKS COMMENCING ON SITE.

TELSTRA & OTHER COMMUNICATION INFRASTRUCTURE TO BE RE-ROUTED SUBJECT TO APPROVAL.

EXISTING PATH TO BE DEMOLISHED SHOWN DASHED

EXISTING CAR PARK TO BE DEMOLISHED SHOWN DASHED

11KV UNDERGROUND HV CABLES COMMISSIONED AND SUBSTATION IN AS ELECTRICAL BOX AS PER TO BE REMOVED AS PART OF THIS DEVELOPMENT.

PATH TO BE DEMOLISHED SHOWN DASHED

HIGH VOLTAGE PYLONS & OVERHEAD POWERLINES (66KV) TO BE RE-LOCATED UNDERGROUND SUBJECT TO APPROVAL

ALL EXISTING TREES ON SITE EXCLUDING THOSE LOCATED WITHIN COVENANT C1 (CLIFF BASE / ENCASCIMENT & SACRED SITE) TO BE REMOVED AND REPLACED - REFER TO LANDSCAPE PLAN BY CLOUSTON ASSOCIATES  
 - TREES SHOWN DASHED IN RED ARE INDICATIVE ONLY. ADDITIONAL TREES NOT SHOWN ON THIS DRAWING MAY REQUIRE REMOVAL

1 SITE PLAN - DEMOLITION 1 : 750

HACHEM ARCHITECTURE INTERIOR MARKETING  
 HACHEM.COM.AU LEVEL 3, 2 DREWERY PLACE 188 WESTON STREET  
 INFO@HACHEM.COM.AU MELBOURNE 3000 BRUNSWICK EAST 3067  
 STUDIO +61 1300 734 560 VICTORIA, AUSTRALIA VICTORIA, AUSTRALIA

The information contained within this and accompanying documents is confidential and commercially sensitive. They are permitted only to be opened, read and used by the addressee. Verify all dimensions and levels on site prior to shop drawing or construction. Do not scale drawings. Figure dimensions must be used in preference to scaled dimensions. Notify Architect of any discrepancies.

REV.	DESCRIPTION	DATE
A	TOWN PLANNING SUBMISSION	19/02/21

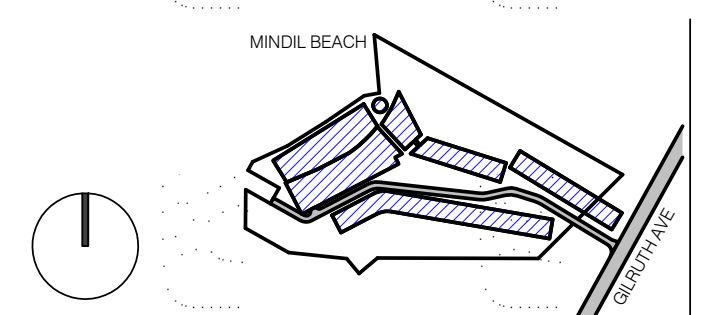

PROJECT LOCATION  
 25 GILRUTH AVENUE,  
 THE GARDENS, DARWIN

CLIENT  
 DAVID DO AWI

DRAWING SCALE  
 1 : 750

DRAWING DATE  
 19/02/21

SHEET SIZE  
 A1

CHECK  
 EP

PROJECT NO  
 257

DRAWN  
 KS



DRAWING TITLE  
 DEMOLITION PLAN

PROJECT NAME  
 LITTLE MINDIL

REVISION  
 BUILDING / ATTRIBUTE  
 A 12°26'59" S  
 130°49'45" E

DRAWING NO.

TOWN PLANNING

TP0.12





1  
TP3.01

EXISTING VEHICLE ACCESS ROAD VIA ADJACENT MINDIL BEACH CASINO CAR PARK ENTRANCE ON CASINO DRIVE TO REMAIN & BE CONNECTED TO PROPOSED INTERNAL ROAD NETWORK.

PROPOSED RELOCATION OF EXISTING PEDESTRIAN PATH & PROPOSED PRAM CROSSING. REFER TO DRIVEWAY CROSSOVER DRAWINGS BY ADJ FOR DESIGN AND DETAILS.

PROPOSED SINGLE VEHICULAR ACCESS POINT / CROSSOVER. REFER TO DRIVEWAY CROSSOVER DRAWINGS BY ADJ FOR DESIGN AND DETAILS.

REFER TO TRAFFIC IMPACT ASSESSMENT PREPARED BY SJ TRAFFIC FOR FURTHER INFORMATION IN REGARD TO THE TRAFFIC GENERATION & ASSOCIATED IMPLICATIONS RELEVANT TO THIS PROPOSAL.

REFER TO VISUAL IMPACT STUDY BY CLOUSTON ASSOCIATES  
CAMERA VIEWS SHOWN IN RED  
- VIEWS 1, 3, 5, 7 ARE FROM 1.7m ABOVE NGL  
- VIEWS 2, 4, 6, 8 ARE FROM 4.5m ABOVE NGL

1 SITE PLAN - PROPOSED 1:750

**HACHEM ARCHITECTURE INTERIOR MARKETING**  
HACHEM.COM.AU LEVEL 3, 2 DREWERY PLACE 183 WESTON STREET  
INFO@HACHEM.COM.AU MELBOURNE 3000 BRUNSWICK EAST 3067  
STUDIO +61 1300 734 560 VICTORIA, AUSTRALIA VICTORIA, AUSTRALIA

The information contained within this and accompanying this document is confidential and commercially sensitive. They are permitted only to be opened, read and used by the addressee. Verify all dimensions and levels on site prior to shop drawing or construction. Do not scale drawings. Figure dimensions must be used in preference to scaled dimensions. Notify Architect of any discrepancies.

REV.	DESCRIPTION	DATE
A	TOWN PLANNING SUBMISSION	19/02/21

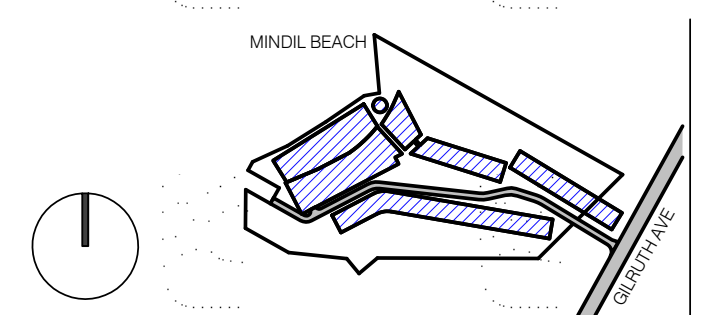

PROJECT LOCATION  
25 GILRUTH AVENUE,  
THE GARDENS, DARWIN

DRAWING SCALE  
1 : 750

SHEET SIZE  
A1

PROJECT NO  
257

CLIENT  
DAVID DO AWI

DRAWING DATE  
19/02/21

CHECK  
EP

DRAWN  
KS



DRAWING TITLE  
PROPOSED SITE PLAN

REVISION  
A

BUILDING / ATTRIBUTE  
12°26'59" S  
130°49'45" E

PROJECT NAME  
LITTLE MINDIL

DRAWING NO.  
TP0.13





HACHEM ARCHITECTURE INTERIOR MARKETING  
 HACHEM.COM.AU LEVEL 3, 9 DREWERY PLACE 183 WESTON STREET  
 INFO@HACHEM.COM.AU MELBOURNE 3000 BRUNSWICK EAST 3057  
 STUDIO +61 1300 734 560 VICTORIA, AUSTRALIA VICTORIA, AUSTRALIA

The information contained within this and accompanying documents is confidential and commercially sensitive. They are permitted only to be opened, read and used by the addressee. Verify all dimensions and levels on site prior to shop drawing or construction. Do not scale drawings. Figure dimensions must be used in preference to scaled dimensions. Notify Architect of any discrepancies.

REV.	DESCRIPTION	DATE
A	TOWN PLANNING SUBMISSION	19/02/21

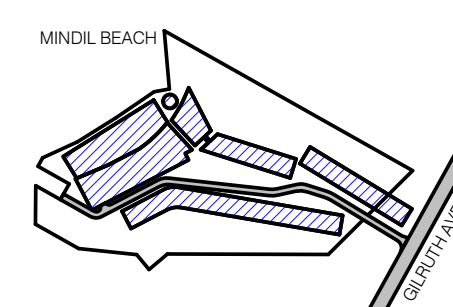

PROJECT LOCATION  
 25 GILRUTH AVENUE,  
 THE GARDENS, DARWIN

DRAWING SCALE: A1  
 SHEET SIZE: A1  
 PROJECT NO: 257

DRAWING DATE: 19/02/21  
 CHECK: EP  
 DRAWN: KS

CLIENT  
 DAVID DO AWI



DRAWING TITLE  
 PERSPECTIVE IMAGES - SHEET 01

PROJECT NAME  
 LITTLE MINDIL

REVISION: A  
 BUILDING / ATTRIBUTE  
 12°26'59" S  
 130°49'45" E

DRAWING NO.

TOWN PLANNING

TP0.21





**HACHEM ARCHITECTURE INTERIOR MARKETING**

HACHEM.COM.AU LEVEL 3, 2 DREWERY PLACE 183 WESTON STREET  
 INFO@HACHEM.COM.AU MELBOURNE 3000 BRUNSWICK EAST 3067  
 STUDIO +61 1300 734 560 VICTORIA, AUSTRALIA VICTORIA, AUSTRALIA

The information contained within this and accompanying this document is confidential and commercially sensitive. They are permitted only to be opened, read and used by the addressee. Verify all dimensions and levels on site prior to shop drawing or construction. Do not scale drawings. Figured dimensions must be used in preference to scaled dimensions. Notify Architect of any discrepancies.

REV.	DESCRIPTION	DATE
A	TOWN PLANNING SUBMISSION	19/02/21

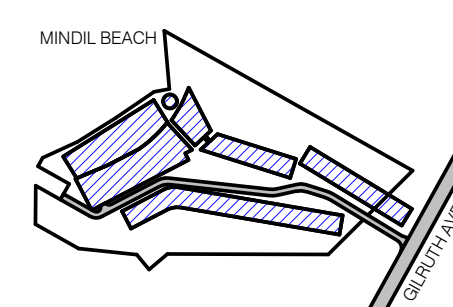

PROJECT LOCATION  
 25 GILRUTH AVENUE,  
 THE GARDENS, DARWIN

DRAWING SCALE SHEET SIZE PROJECT NO  
 A1 257

CLIENT  
 DAVID DO AWI

DRAWING DATE CHECK DRAWN  
 19/02/21 EP KS



DRAWING TITLE  
 PERSPECTIVE IMAGES - SHEET 02

PROJECT NAME  
 LITTLE MINDIL

REVISION BUILDING / ATTRIBUTE  
 A 12°26'59" S  
 130°49'45" E

DRAWING NO.

TOWN PLANNING

**TP0.22**



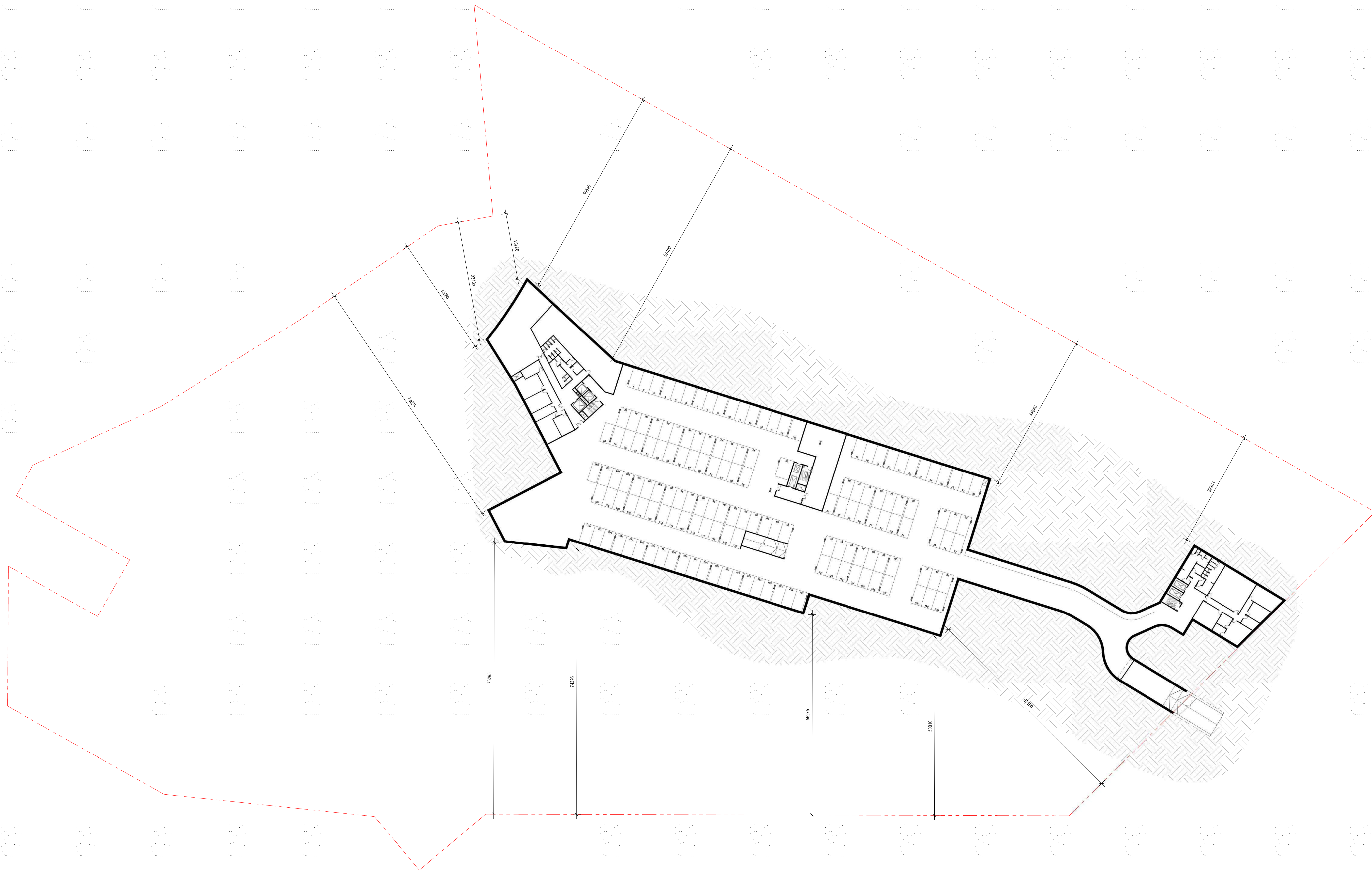

1 OVERALL PLAN - SEMI-BASEMENT 01  
1 : 500

**HACHEM ARCHITECTURE INTERIOR MARKETING**  
 HACHEM.COM.AU LEVEL 3, 2 DREWERY PLACE 183 WESTON STREET  
 INFO@HACHEM.COM.AU MELBOURNE 3000 BRUNSWICK EAST 3067  
 STUDIO +61 1300 734 560 VICTORIA, AUSTRALIA VICTORIA, AUSTRALIA

The information contained within this and accompanying documents is confidential and commercially sensitive. They are permitted only to be opened, read and used by the addressee. Verify all dimensions and levels on site prior to shop drawing or construction. Do not scale drawings. Figure dimensions must be used in preference to scaled dimensions. Notify Architect of any discrepancies.

REV.	DESCRIPTION	DATE
A	TOWN PLANNING SUBMISSION	19/02/21

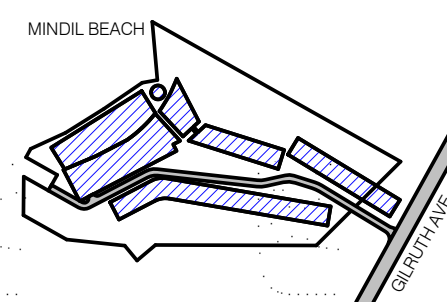
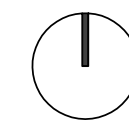

PROJECT LOCATION  
 25 GILRUTH AVENUE,  
 THE GARDENS, DARWIN  
 CLIENT  
 DAVID DO AWI

DRAWING SCALE  
 1 : 500  
 SHEET SIZE  
 A1  
 PROJECT NO.  
 257  
 DRAWING DATE  
 19/02/21  
 CHECK  
 EP  
 DRAWN  
 KS



DRAWING TITLE  
 OVERALL PLAN - SEMI-BASEMENT  
 PROJECT NAME  
 LITTLE MINDIL

REVISION  
**A**  
 BUILDING / ATTRIBUTE  
 12°26'59" S  
 130°49'45" E  
 DRAWING NO.

TOWN PLANNING  
**TP1.01**



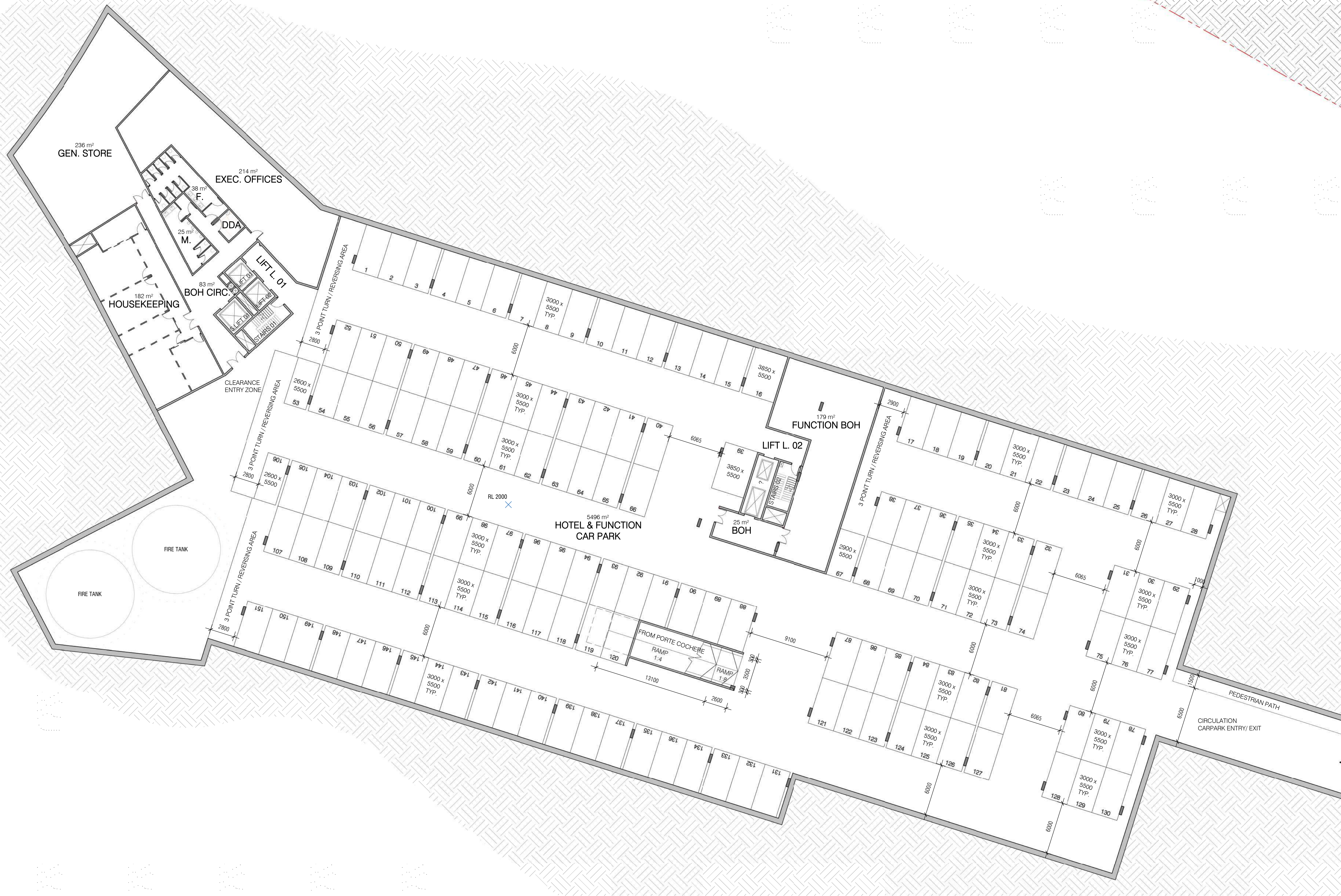

REFER TO TP1.03 /1  
FOR ADDITIONAL INFORMATION

**1** SEMI-BASEMENT PLAN - HOTEL  
1 : 250

HACHEM ARCHITECTURE INTERIOR MARKETING  
HACHEM.COM.AU INFO@HACHEM.COM.AU STUDIO +61 1300 734 560  
LEVEL 3, 2 DREWERY PLACE MELBOURNE 3000 VICTORIA, AUSTRALIA  
183 WESTON STREET BRUNSWICK EAST 3067 VICTORIA, AUSTRALIA

The information contained within this and accompanying this document is confidential and commercially sensitive. They are permitted only to be opened, read and used by the addressee. Verify all dimensions and levels on site prior to shop drawing or construction. Do not scale drawings. Figure dimensions must be used in preference to scaled dimensions. Notify Architect of any discrepancies.

REV.	DESCRIPTION	DATE
A	TOWN PLANNING SUBMISSION	19/02/21

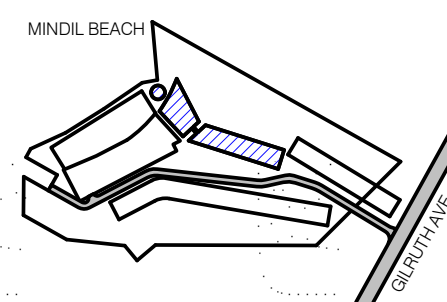

PROJECT LOCATION  
25 GILRUTH AVENUE,  
THE GARDENS, DARWIN

DRAWING SCALE: 1 : 250  
SHEET SIZE: A1  
PROJECT NO: 257  
DRAWING DATE: 19/02/21  
CHECK: EP  
DRAWN: KS

CLIENT: DAVID DO AWI



DRAWING TITLE  
FLOOR PLAN - SEMI-BASEMENT -  
HOTEL - PART A

PROJECT NAME  
LITTLE MINDIL

REVISION: **A**  
BUILDING / ATTRIBUTE: 12°26'59" S 130°49'45" E

DRAWING NO.

TOWN PLANNING

**TP1.02**



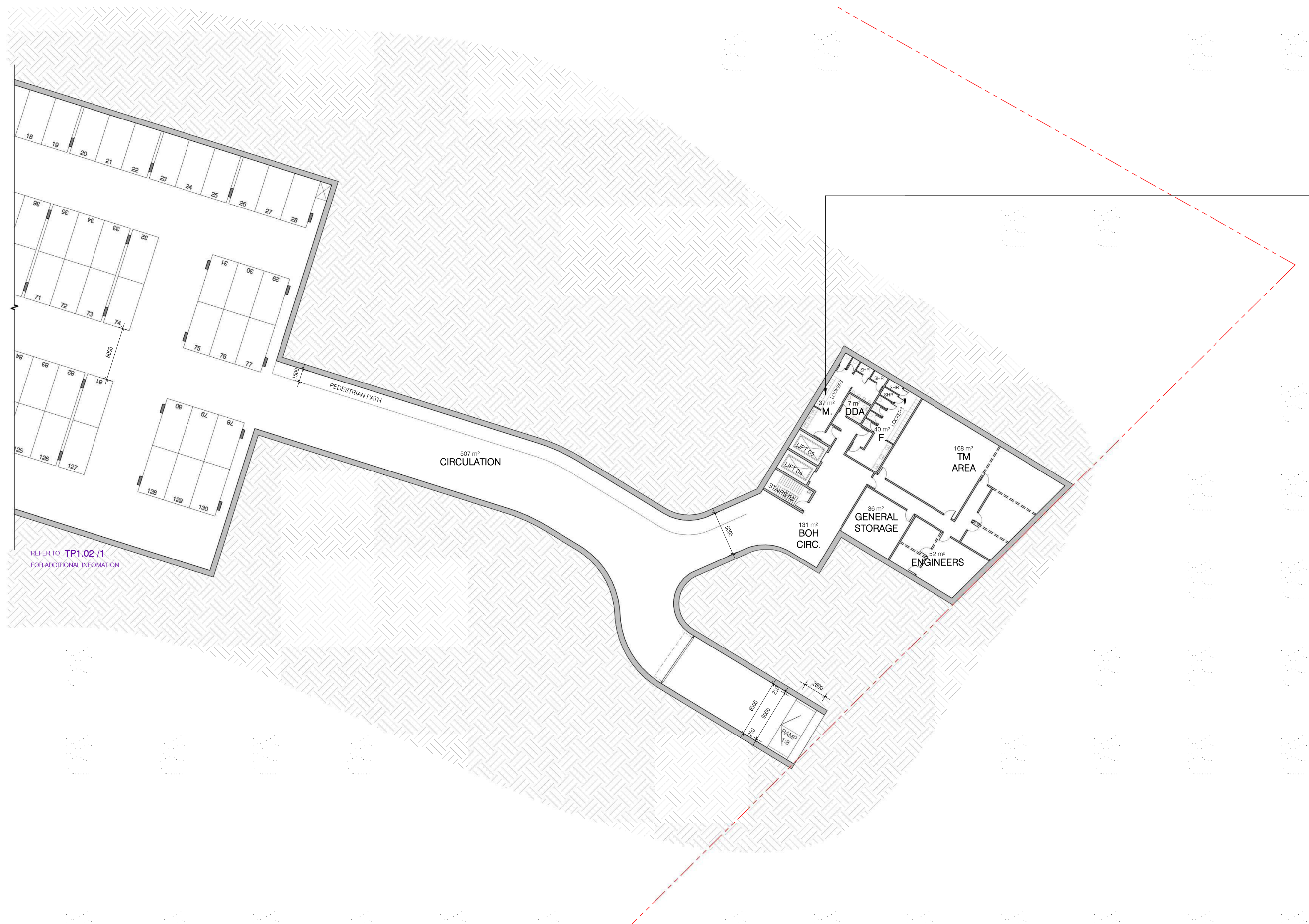

END OF TRIP FACILITIES TO BE PROVIDED AND TO COMPLY WITH AS2890.3 AND NTPS CLAUSE 5.3.7  
 - 72 LOCKERS INCLUDED - ONE LOCKER PER SECURE BICYCLE SPACE TO PROVIDED.  
 - 4 SHOWERS TOTAL PROVIDED (2 x MALE, 2 x FEMALE), ASSUMING 200 STAFF TOTAL.  
 INDICATIVE ONLY - LAYOUT TO BE MODIFIED AS REQUIRED TO TO COMPLY ONCE STAFF NUMBERS ARE CONFIRMED.

REFER TO TP1.02 /1 FOR ADDITIONAL INFORMATION

**1 SEMI-BASEMENT PLAN - HOTEL VILLAS**  
 1 : 250

**HACHEM ARCHITECTURE INTERIOR MARKETING**  
 HACHEM.COM.AU LEVEL 3, 2 DREWERY PLACE 183 WESTON STREET  
 INFO@HACHEM.COM.AU MELBOURNE 3000 BRUNSWICK EAST 3067  
 STUDIO +61 1300 734 560 VICTORIA, AUSTRALIA VICTORIA, AUSTRALIA

The information contained within this and accompanying this document is confidential and commercially sensitive. They are permitted only to be opened, read and used by the addressee. Verify all dimensions and levels on site prior to shop drawing or construction. Do not scale drawings. Figure dimensions must be used in preference to scaled dimensions. Notify Architect of any discrepancies.

C:\Users\jwehster\Documents\257\_LITTLE MINDIL\_AS\_R19\_kevin@hachem.com.au.rvt 12/05/2021 11:28:59 AM

REV.	DESCRIPTION	DATE
A	TOWN PLANNING SUBMISSION	19/02/21

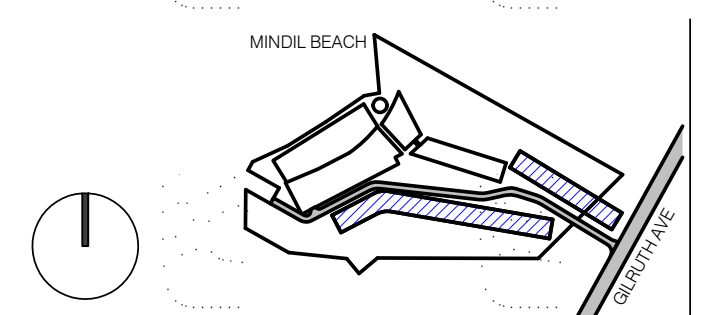

PROJECT LOCATION  
 25 GILRUTH AVENUE,  
 THE GARDENS, DARWIN

DRAWING SCALE: 1 : 250  
 SHEET SIZE: A1  
 PROJECT NO: 257

DRAWING DATE: 19/02/21  
 CHECK: EP  
 DRAWN: KS



DRAWING TITLE  
**FLOOR PLAN - SEMI-BASEMENT - HOTEL - PART B**

PROJECT NAME  
 LITTLE MINDIL

REVISION: **A**  
 BUILDING / ATTRIBUTE: 12°26'59" S 130°49'45" E

DRAWING NO.  
**TP1.03**

TOWN PLANNING





1 OVERALL PLAN - GROUND LEVEL  
1 : 500

HACHEM ARCHITECTURE INTERIOR MARKETING  
 HACHEM.COM.AU LEVEL 3, 2 DREWEERY PLACE 183 WESTON STREET  
 INFO@HACHEM.COM.AU MELBOURNE 3000 BRUNSWICK EAST 3057  
 STUDIO +61 1300 734 560 VICTORIA, AUSTRALIA VICTORIA, AUSTRALIA

The information contained within this and accompanying documents is confidential and commercially sensitive. They are permitted only to be opened, read and used by the addressee. Verify all dimensions and levels on site prior to shop drawing or construction. Do not scale drawings. Figure dimensions must be used in preference to scaled dimensions. Notify Architect of any discrepancies.

REV.	DESCRIPTION	DATE
B	TOWN PLANNING - ADDITIONAL INFORMATION	12/05/21
A	TOWN PLANNING SUBMISSION	19/02/21

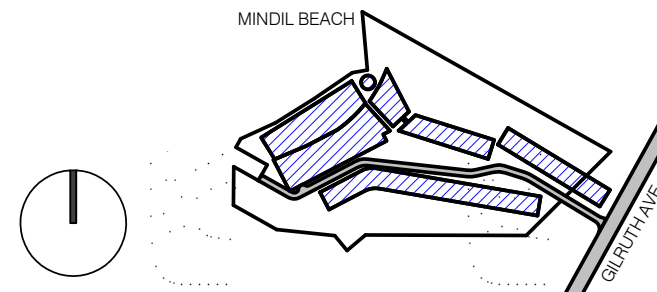

PROJECT LOCATION  
 25 GILRUTH AVENUE,  
 THE GARDENS, DARWIN

CLIENT  
 DAVID DO AWI

DRAWING SCALE  
 1 : 500

DRAWING DATE  
 12/05/21

SHEET SIZE  
 A1

CHECK  
 EP

PROJECT NO  
 257

DRAWN  
 KS



DRAWING TITLE  
 OVERALL PLAN - GROUND LEVEL

REVISION  
**B**

BUILDING / ATTRIBUTE  
 12°26'59" S  
 130°49'45" E

PROJECT NAME  
 LITTLE MINDIL

DRAWING NO.  
 TP1.04

TOWN PLANNING





1 GROUND PLAN - SERVICED APARTMENTS / LUXURY VILLAS  
1 : 250

HACHEM ARCHITECTURE INTERIOR MARKETING  
 HACHEM.COM.AU LEVEL 3, 2 DREWERY PLACE 188 WESTON STREET  
 INFO@HACHEM.COM.AU MELBOURNE 3000 BRUNSWICK EAST 3067  
 STUDIO +61 1300 734 560 VICTORIA, AUSTRALIA VICTORIA, AUSTRALIA

The information contained within this and accompanying documents is confidential and commercially sensitive. They are permitted only to be opened, read and used by the addressee. Verify all dimensions and levels on site prior to shop drawing or construction. Do not scale drawings. Figure dimensions must be used in preference to scaled dimensions. Notify Architect of any discrepancies.

REV.	DESCRIPTION	DATE
A	TOWN PLANNING SUBMISSION	19/02/21

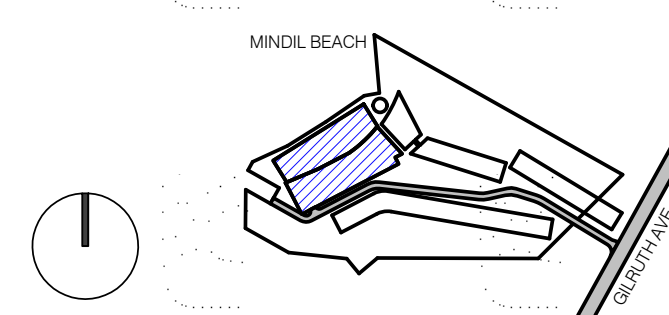

PROJECT LOCATION  
 25 GILRUTH AVENUE,  
 THE GARDENS, DARWIN

CLIENT  
 DAVID DO AWI

DRAWING SCALE  
 1 : 250

DRAWING DATE  
 19/02/21

SHEET SIZE  
 A1

CHECK  
 EP

PROJECT NO  
 257

DRAWN  
 KS



DRAWING TITLE  
 FLOOR PLAN - GROUND LEVEL -  
 SERVICED APARTMENTS /  
 FORESHORE VILLAS

PROJECT NAME  
 LITTLE MINDIL

REVISION  
 BUILDING / ATTRIBUTE  
**A** 12°26'59" S  
 130°49'45" E

DRAWING NO.  
**TP1.05**

TOWN PLANNING



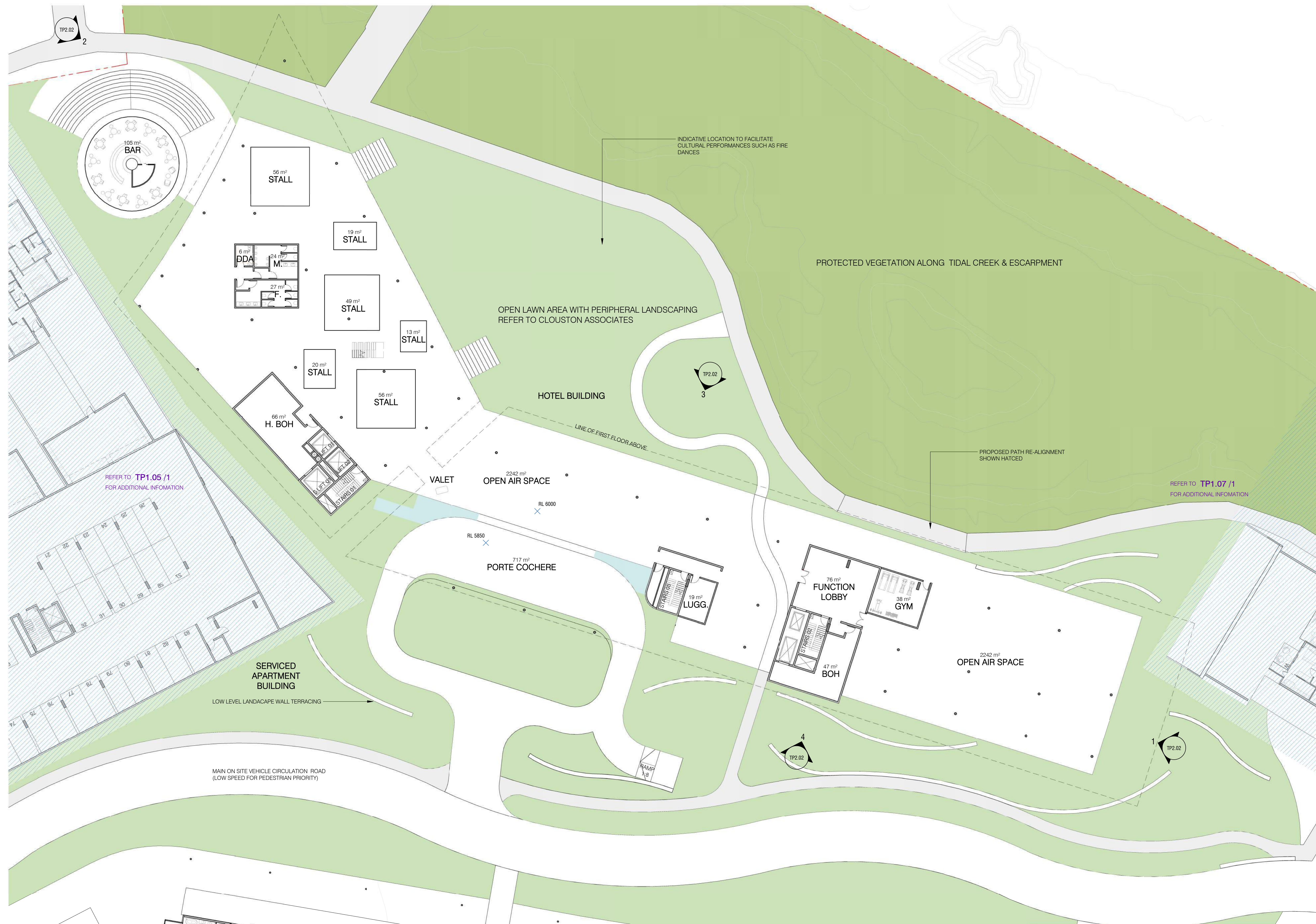

1 GROUND PLAN - HOTEL 1 : 250

HACHEM ARCHITECTURE INTERIOR MARKETING  
 HACHEM.COM.AU LEVEL 3, 2 DREWERY PLACE 188 WESTON STREET  
 INFO@HACHEM.COM.AU MELBOURNE 3000 BRUNSWICK EAST 3067  
 STUDIO +61 1300 734 560 VICTORIA, AUSTRALIA VICTORIA, AUSTRALIA

The information contained within this and accompanying documents is confidential and commercially sensitive. They are permitted only to be opened, read and used by the addressee. Verify all dimensions and levels on site prior to shop drawing or construction. Do not scale drawings. Figure dimensions must be used in preference to scaled dimensions. Notify Architect of any discrepancies.

REV.	DESCRIPTION	DATE
A	TOWN PLANNING SUBMISSION	19/02/21

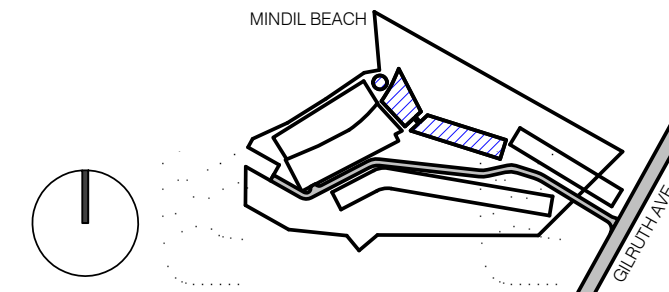

PROJECT LOCATION  
 25 GILRUTH AVENUE,  
 THE GARDENS, DARWIN

CLIENT  
 DAVID DO AWI

DRAWING SCALE  
 1 : 250

DRAWING DATE  
 19/02/21

SHEET SIZE  
 A1

CHECK  
 EP

PROJECT NO  
 257

DRAWN  
 KS



DRAWING TITLE  
 FLOOR PLAN - GROUND LEVEL -  
 HOTEL

PROJECT NAME  
 LITTLE MINDIL

REVISION  
**A**

BUILDING / ATTRIBUTE  
 12°26'59" S  
 130°49'45" E

DRAWING NO.  
**TP1.06**

TOWN PLANNING





REFER TO TP1.08/1 FOR ADDITIONAL INFORMATION

1 GROUND PLAN - HOTEL VILLAS - PART A

1:250

**HACHEM ARCHITECTURE INTERIOR MARKETING**  
 HACHEM.COM.AU LEVEL 3, 2 DREWERY PLACE 183 WESTON STREET  
 INFO@HACHEM.COM.AU MELBOURNE 3000 BRUNSWICK EAST 3057  
 STUDIO +61 1300 734 560 VICTORIA, AUSTRALIA VICTORIA, AUSTRALIA

The information contained within this and accompanying documents is confidential and commercially sensitive. They are permitted only to be opened, read and used by the addressee. Verify all dimensions and levels on site prior to shop drawing or construction. Do not scale drawings. Figure dimensions must be used in preference to scaled dimensions. Notify Architect of any discrepancies.

REV.	DESCRIPTION	DATE
A	TOWN PLANNING SUBMISSION	19/02/21

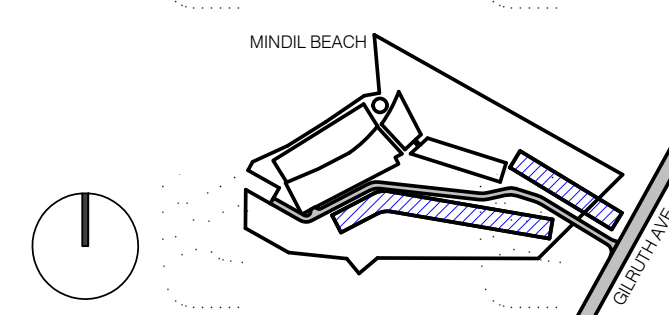

PROJECT LOCATION  
 25 GILRUTH AVENUE,  
 THE GARDENS, DARWIN

CLIENT  
 DAVID DO AWI

DRAWING SCALE  
 1 : 250

DRAWING DATE  
 19/02/21

SHEET SIZE  
 A1

CHECK  
 EP

PROJECT NO  
 257

DRAWN  
 KS



DRAWING TITLE  
 FLOOR PLAN - GROUND LEVEL -  
 GARDEN & LAGOON VILLAS - PART  
 A

PROJECT NAME  
 LITTLE MINDIL

REVISION  
 BUILDING / ATTRIBUTE  
 A 12°26'59" S  
 130°49'45" E

DRAWING NO.

TOWN PLANNING

TP1.07





REFER TO TP1.07/1 FOR ADDITIONAL INFORMATION

1 GROUND PLAN - HOTEL VILLAS - PART B  
1:250

HACHEM ARCHITECTURE INTERIOR MARKETING  
 HACHEM.COM.AU LEVEL 3, 2 DREWERY PLACE 183 WESTON STREET  
 INFO@HACHEM.COM.AU MELBOURNE 3000 BRUNSWICK EAST 3067  
 STUDIO +61 1300 734 560 VICTORIA, AUSTRALIA VICTORIA, AUSTRALIA

The information contained within this and accompanying documents is confidential and commercially sensitive. They are permitted only to be opened, read and used by the addressee. Verify all dimensions and levels on site prior to shop drawing or construction. Do not scale drawings. Figure dimensions must be used in preference to scaled dimensions. Notify Architect of any discrepancies.

REV.	DESCRIPTION	DATE
A	TOWN PLANNING SUBMISSION	19/02/21

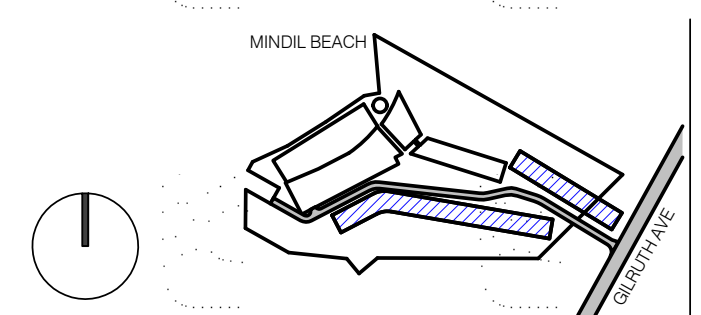

PROJECT LOCATION  
 25 GILRUTH AVENUE,  
 THE GARDENS, DARWIN

CLIENT  
 DAVID DO AWI

DRAWING SCALE  
 1:250

DRAWING DATE  
 19/02/21

SHEET SIZE  
 A1

CHECK  
 EP

PROJECT NO.  
 257

DRAWN  
 KS



DRAWING TITLE  
 FLOOR PLAN - GROUND LEVEL -  
 LAGOON VILLAS - PART B

PROJECT NAME  
 LITTLE MINDIL

REVISION  
**A**

BUILDING / ATTRIBUTE  
 12°26'59" S  
 130°49'45" E

DRAWING NO.  
**TP1.08**

TOWN PLANNING



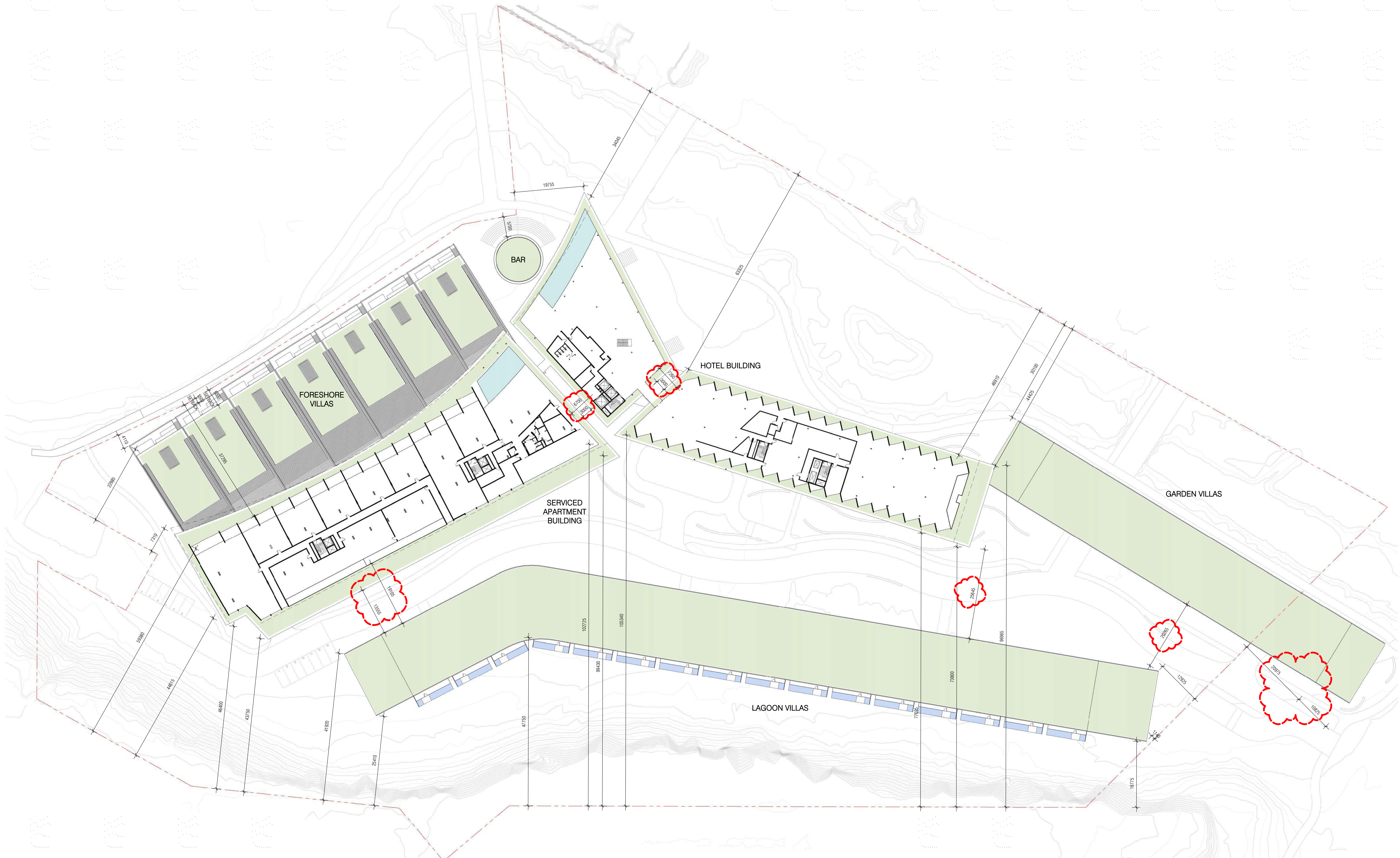

**1** OVERALL PLAN - LEVEL 01  
1:500

**HACHEM ARCHITECTURE INTERIOR MARKETING**  
 HACHEM.COM.AU    LEVEL 3, 2 DREWERY PLACE    183 WESTON STREET  
 INFO@HACHEM.COM.AU    MELBOURNE 3000    BRUNSWICK EAST 3067  
 STUDIO +61 1300 734 560    VICTORIA, AUSTRALIA    VICTORIA, AUSTRALIA

The information contained within this and accompanying documents is confidential and commercially sensitive. They are permitted only to be opened, read and used by the addressee. Verify all dimensions and levels on site prior to shop drawing or construction. Do not scale drawings. Figure dimensions must be used in preference to scaled dimensions. Notify Architect of any discrepancies.

REV.	DESCRIPTION	DATE
B	TOWN PLANNING - ADDITIONAL INFORMATION	12/05/21
A	TOWN PLANNING SUBMISSION	19/02/21

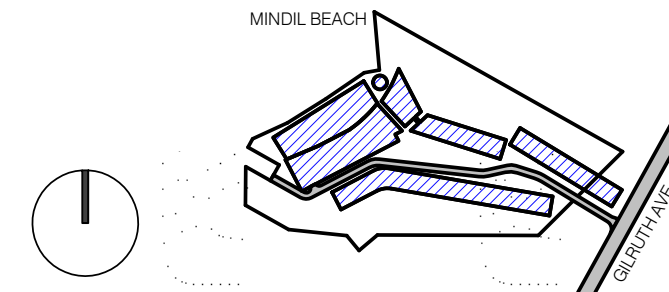

PROJECT LOCATION  
 25 GILRUTH AVENUE,  
 THE GARDENS, DARWIN

DRAWING SCALE  
 1:500

SHEET SIZE  
 A1

PROJECT NO  
 257

CLIENT  
 DAVID DO AWI

DRAWING DATE  
 12/05/21

CHECK  
 EP

DRAWN  
 KS



DRAWING TITLE  
 OVERALL PLAN - LEVEL 01

PROJECT NAME  
 LITTLE MINDIL

REVISION  
**B**

DRAWING NO.  
**TP1.09**

TOWN PLANNING

BUILDING / ATTRIBUTE  
 12°26'59" S  
 130°49'45" E

**TP1.09**



TIMBER SCREENING TO ALLOW NATURAL LIGHT & VENTILATION TO P.O.S BELOW WHILST PRECLUDING OVERLOOKING FROM SERVICED APARTMENTS LOCATED AT HIGHER LEVELS

FORESHORE VILLAS  
LANDSCAPED ROOF  
REFER TO LANDSCAPE PLAN BY CLOUSTON ASSOCIATES FOR LANDSCAPE DESIGN AND DETAILS

REFER TO TP1.11 / 1 FOR ADDITIONAL INFORMATION



LEVEL 01 PLAN - APARTMENTS / ROOF PLAN - LUXURY VILLAS

1 : 250

HACHEM ARCHITECTURE INTERIOR MARKETING

HACHEM.COM.AU LEVEL 3, 2 DREWERY PLACE 183 WESTON STREET  
INFO@HACHEM.COM.AU MELBOURNE 3000 BRUNSWICK EAST 3067  
STUDIO +61 1300 734 560 VICTORIA, AUSTRALIA VICTORIA, AUSTRALIA

The information contained within this and accompanying documents is confidential and commercially sensitive. They are permitted only to be opened, read and used by the addressee. Verify all dimensions and levels on site prior to shop drawing or construction. Do not scale drawings. Figure dimensions must be used in preference to scaled dimensions. Notify Architect of any discrepancies.

REV.	DESCRIPTION	DATE
A	TOWN PLANNING SUBMISSION	19/02/21

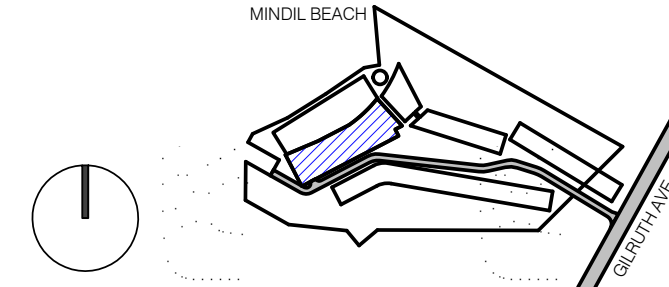

PROJECT LOCATION  
25 GILRUTH AVENUE,  
THE GARDENS, DARWIN

CLIENT  
DAVID DO AWI

DRAWING SCALE 1 : 250  
SHEET SIZE A1  
PROJECT NO 257

DRAWING DATE 19/02/21  
CHECK EP  
DRAWN KS



DRAWING TITLE  
FLOOR PLAN - LEVEL 01 -  
SERVICED APARTMENTS / ROOF  
PLAN - FORESHORE VILLAS

PROJECT NAME  
LITTLE MINDIL

REVISION BUILDING / ATTRIBUTE  
A 12°26'59" S  
130°49'45" E

DRAWING NO.

TOWN PLANNING

TP1.10