



AB Consulting (NT) Pty Ltd

ABN: 98 602 384 672

Shop 4 / 290 Whitewood Road (Cnr Smyth Rd)
HOWARD SPRINGS NT 0835

PO Box 1631, BERRIMAH NT 0828

Mobile: 0400 518 367

Email: annette@abconsultingnt.com.au

Our Ref: ABC-22046

To Whom it may concern,

RE: Statement from a Building Certifier Re: Section 46(3)(k) of the Planning Act for Proposed Subdivision of Lots 1841, 1842 & 1843 (440, 450 & 460) McMillans Road, Marrara, Hundred of Bagot.

In accordance with Section 46(3)(k) of the Planning Act and Cunnington Rosse Subdivision Plans (6 pages) attached, I can confirm that the proposal is suitable for Subdivision and will not affect compliance with the NT Building Act or National Construction Code/Building Code of Australia subject to:

-
- Retained Residential Buildings to be a minimum 900mm from allotment boundaries in order to comply with the NCC Part 3.7.2 – Fire Safety
-

Yours Sincerely,

Annette Joseland

Building Certifier

Registration Number: 264433BU

02/03/2022

Documents Enclosed: Cunnington Rosse Subdivision Plans (6 Pages)

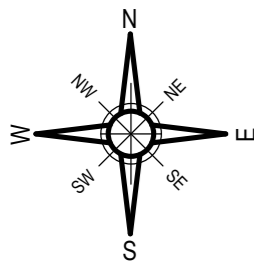

Blue dash line denotes extent of 2.3m high proposed sound barrier in Stage 1

Red dash line denotes separation of Stage 1 & Stage 2

TA denotes a turnaround area for vehicles in Stage 01 and will be converted to park and Lot 83 in Stage 02

Park 01 will be 6640 m² once Stage 02 is complete

Subdivision Plan - Stage 1
1:1500 @ A3

Stage 1 Subdivision Plan
1:1500@ A3

Stage 1 - Subdivision Plan
Proposed Subdivision

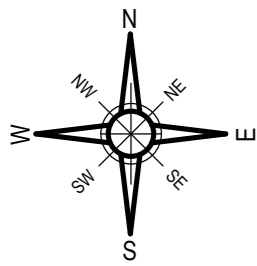

10m
22.5m
Lot Type 1 - 300m² - 449m²
(Lots 10, 11, 12, 16, 17, 20, 56, 61, 64, 71, 76, 79)

11m
22.5m
Lot Type 2 - 450m² - 599m²
(Lots 3, 4, 5, 8, 9, 13, 18, 22, 24, 25, 27, 28, 29, 30, 31, 32, 33, 35, 36, 37, 38, 39, 40, 41, 42, 47, 48, 49, 50, 51, 52, 53, 54, 55, 57, 58, 59, 60, 62, 63, 65, 66, 67, 68, 72, 73, 74, 75, 77, 78)

12m
22.5m
Lot Type 2a - 450m² - 599m² - (Corner Lots)
(Lots 6, 7, 15, 21, 23, 69, 70)

20m
24.5m
Lot Type 3 - 600m² +
(Lots 1, 2, 19, 26, 34, 43, 44, 45, 46, 80)

21m
24.5m
Lot Type 3a - 600m² + (Corner Lots)
(Lots 14)



Stage 1 - Building Envelope Plan
1:1500 @ A3

Stage 1 - Building Envelope Plan
Proposed Subdivision

Mobile: 0427 796 140
Email: brad@crtpc.com.au
www.cunningtonrossetownplanning.com.au



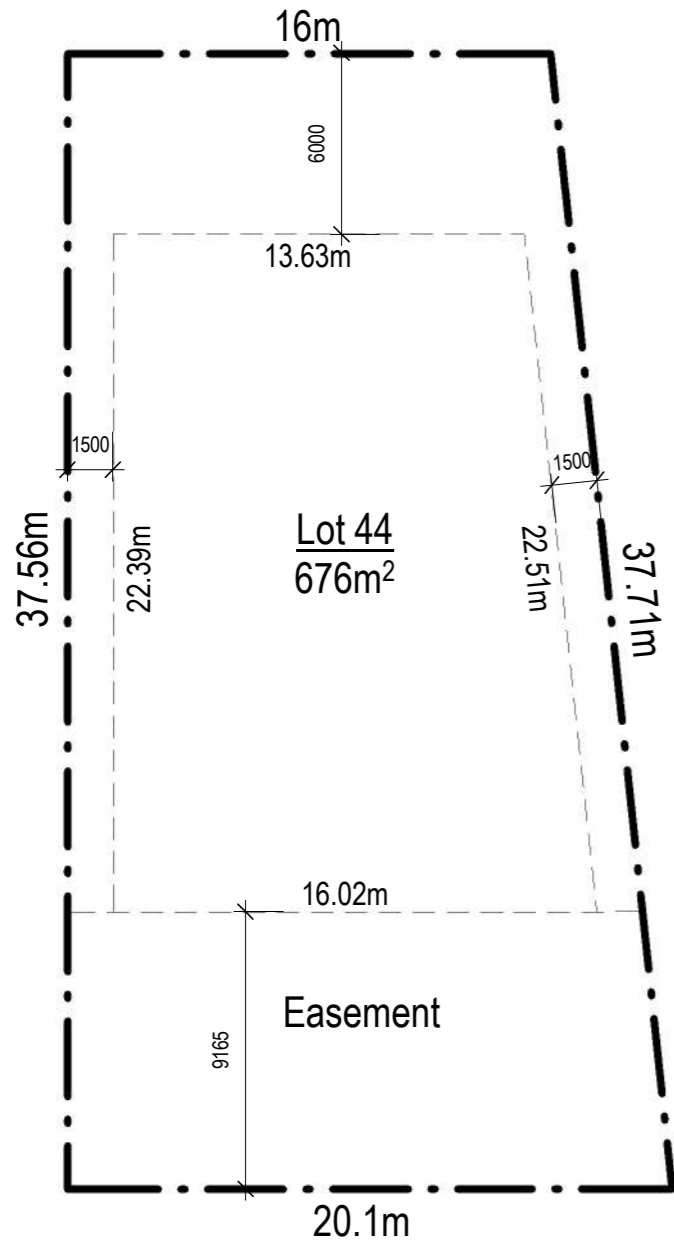

Lot 44 - Envelope Plan

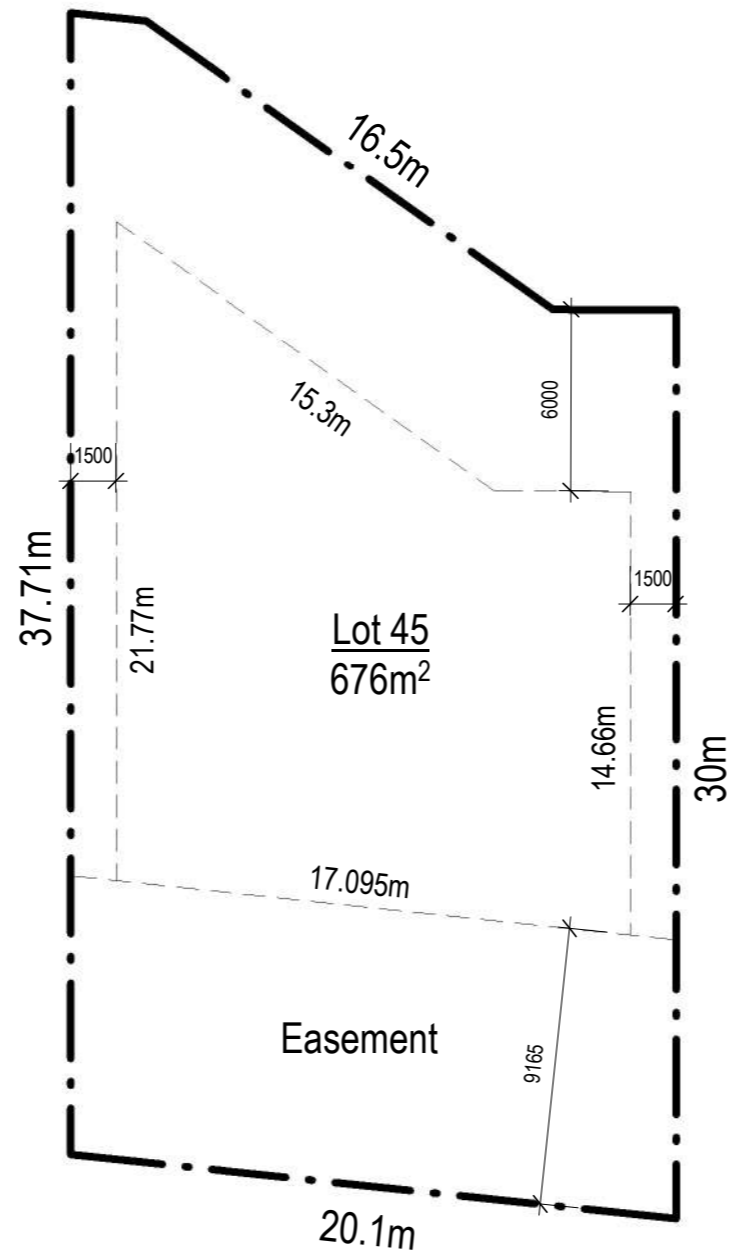

Lot 45 - Envelope Plan

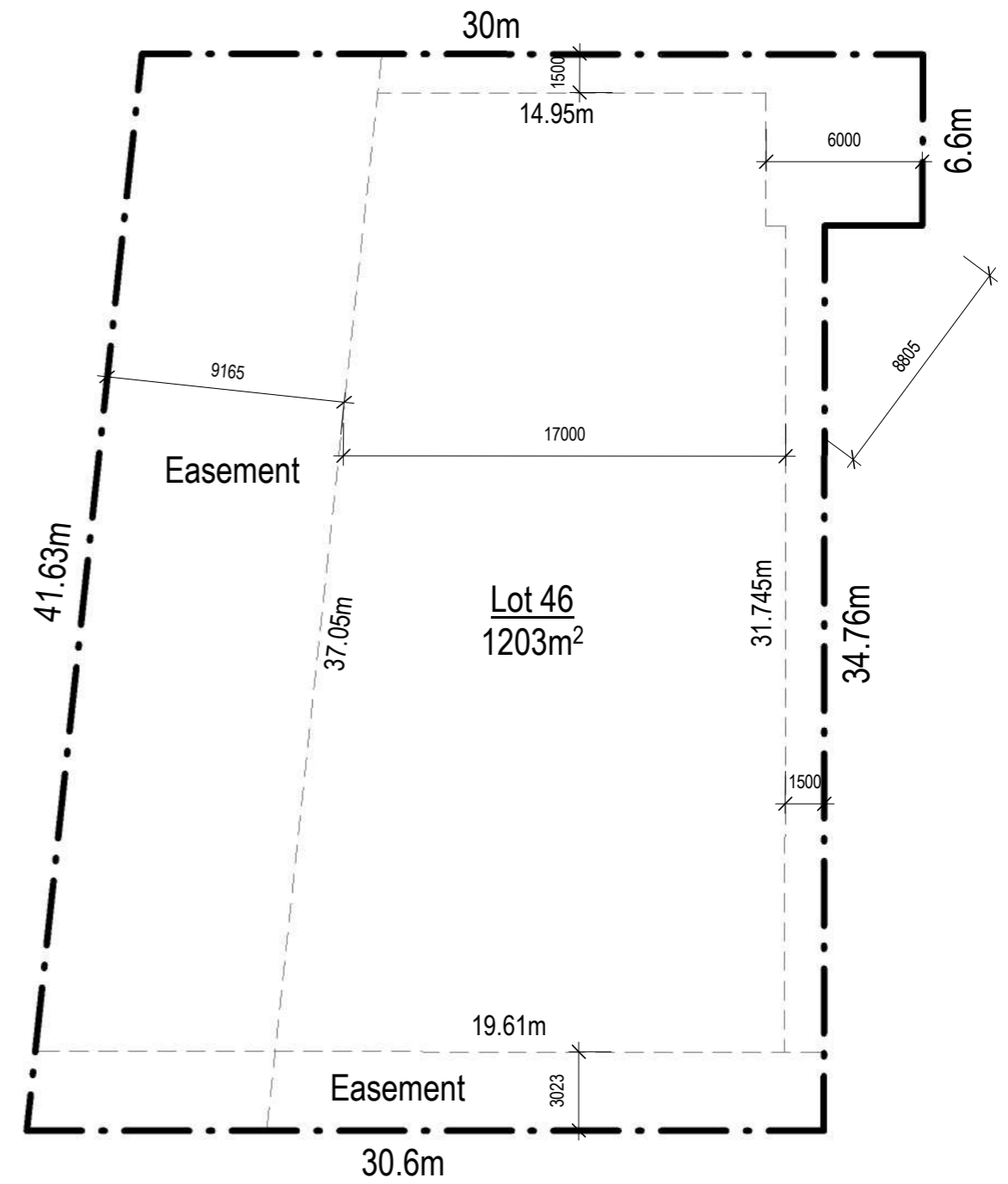

Lot 46 - Envelope Plan

Envelope Plans
Proposed Subdivision

